

SIoux TOOLS PRODUCT BROCHURE | ABRASIVE

# METAL WORKING SERIES

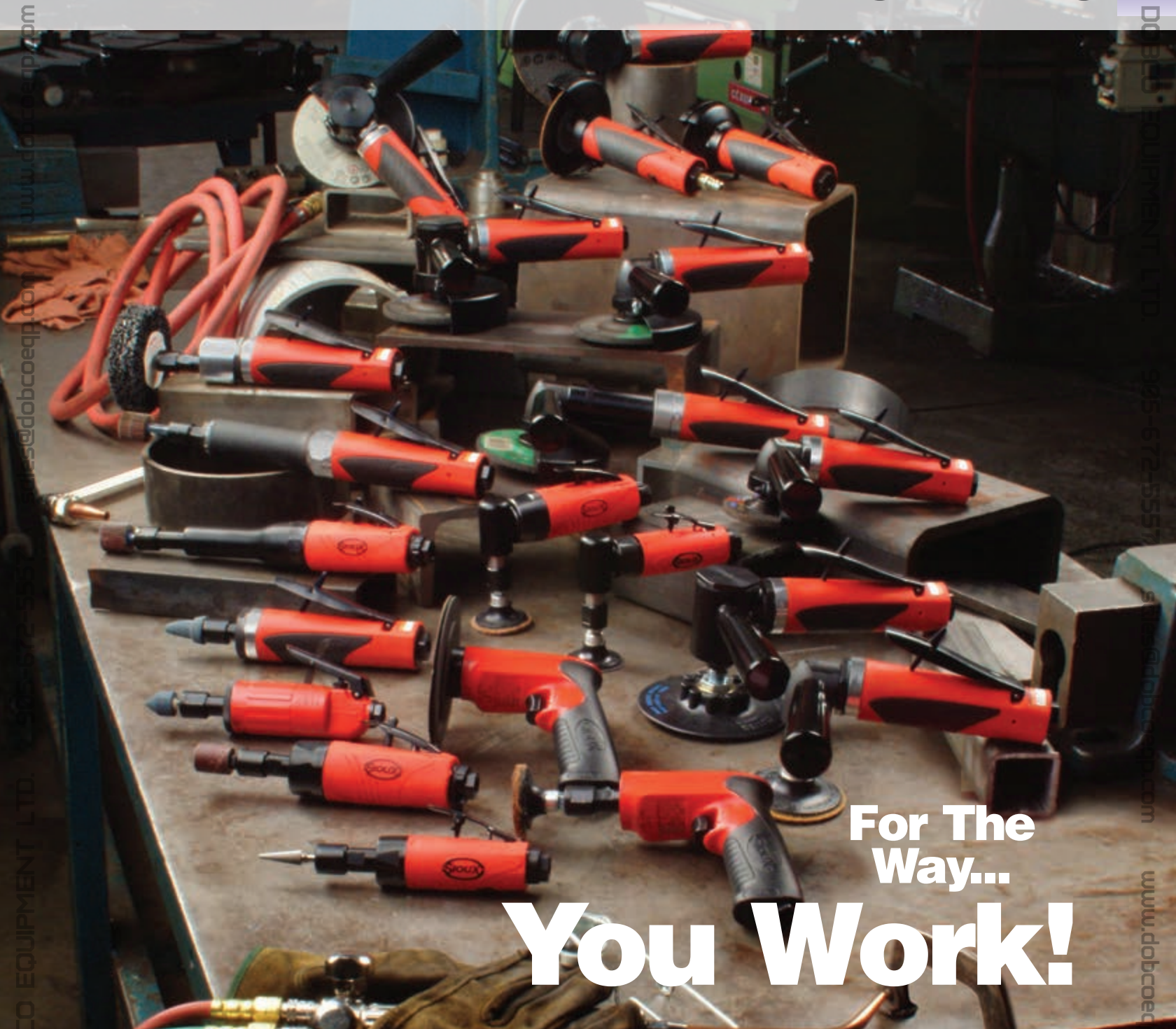

For The  
Way...

# You Work!



DOBCO EQUIPMENT LTD. | www.dobcoequip.com

DOBCO EQUIPMENT LTD. | www.dobcoequip.com

# METAL WORKING

## SERIES

The right choice for grinding, cutting, weld dressing, blending & finishing, deburring, surface prep, finishing and cleaning.

Sioux Signature Series Tools introduce a unique approach to performance power tools. Starting with precision machined components and powerful, efficient motors, Sioux Tools combines modular designs with comfortable compact tool bodies and proven reliability to deliver a wide range of easy-to-handle and easy to service pneumatic tools. The legendary Sioux heritage delivers unmatched performance and maximum productivity.

### Performance

- Powerful motors deliver consistent power and working speeds (from 8-25,000 rpm) for heavy loads
- Heavy-duty, precision-ground, dual-tapered collets provide secure clamp loads and deliver superior run out characteristics
- Responsive Teasing Throttles provide excellent control
- Precision Machined Heat Treated Spiral Bevel Gears for smooth operation and maximum life

### Ergonomics

- Comfortable, compact tool bodies measure only 1.67" (43 mm) in diameter
- Contoured safety levers and ergonomic composite handles with textured grip
- Low noise and vibration levels for comfort in extended use operations

### Serviceability

- Drop in motors with no alignment required on 1 hp models
- No press fits & no shims = quick easy maintenance
- High part interchangeability = lower service part inventories

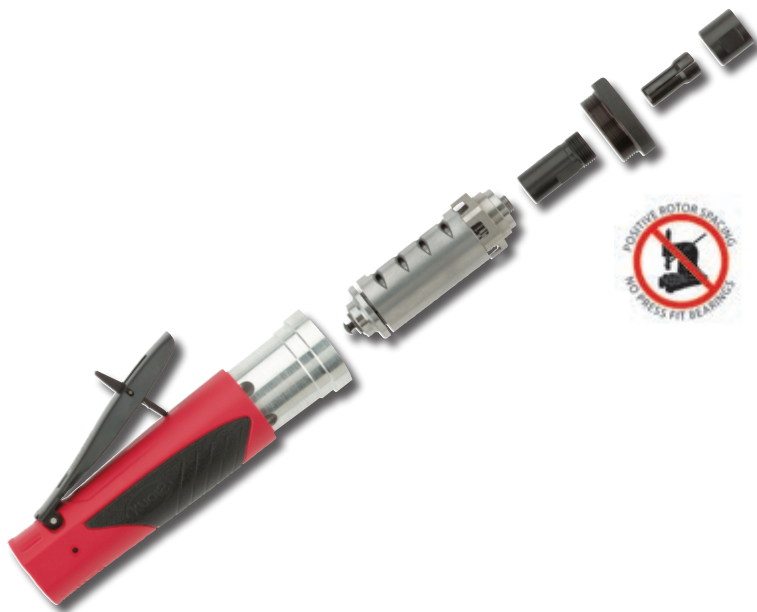

# Signature Series Abrasive Tool Features



Adjustable Wheel Guard Can Be Adjusted Quickly Without Removing The Grinding Wheel



Indexable Angle Head Allows User To Choose From (4) Throttle Positions

Double Ball Bearings for Smooth Operation

Heavy Duty Spiral Bevel Gears for Smooth Operation and Long Life

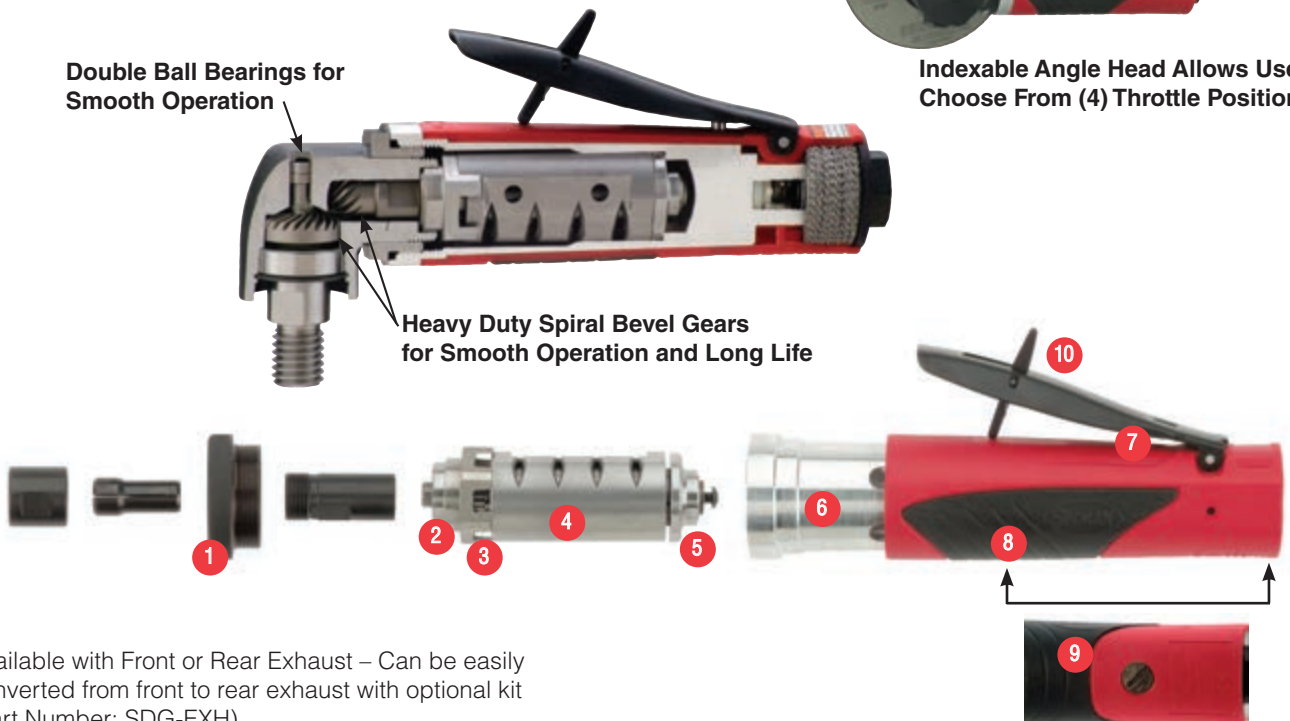

- 1 Available with Front or Rear Exhaust – Can be easily converted from front to rear exhaust with optional kit (Part Number: SDG-EXH)
- 2 Ball Bearing Construction
- 3 Positive Rotor Spacing • Rotor spacing remains secure and does not rely on a press fit • Maintenance and service is quick and easy
- 4 Precision Machined Powdered Metal Cylinder
- 5 Precision Machined Steel End Plates
- 6 Aluminum Housing with glass filled nylon cover
- 7 Ergonomic Teasing Throttle
- 8 Compact Tool Bodies with Over Molded Comfort Grip provide a secure grip
- 9 Built-in Speed Control
- 10 Lever Lock

STRAIGHT DIE GRINDERS



Features:

- Powerful 5 vane motors deliver high working speeds
- Heavy duty double tapered collet
- Ergonomic comfort grip
- Teasing throttle for maximum control
- Lever throttle with lock-off
- Ball bearing construction
- Adjustable speed control

Straight Die Grinders



Model Number	Free Speed	Weight		Length		Sound Level	Air Consumption		Collet Size	Exhaust
	rpm	lb	kg	in	mm	dB(A)	cfm	l/s		
<b>0.3 hp (0.22 kW) - Lever Throttle - 200 Series Collet</b>										
SDG03S25	25,000	1	0.45	6.25	160	84.3	11	5.2	1/4"	Rear
SDG03S25M6	25,000	1	0.45	6.25	160	83.3	11	5.2	6 mm	Rear
<b>0.3 hp (0.22 kW) - Lever Throttle - 300 Series Collet</b>										
SDG03S25S	25,000	1	0.45	6.25	160	83.3	11	5.2	1/4"	Rear
SDG03S25M6S	25,000	1	0.45	6.25	160	83.3	11	5.2	6mm	Rear
<b>0.5 hp (0.37 kW) - Lever Throttle - 200 Series Collet</b>										
SDG05S18	18,000	1.2	0.54	7	180	82.4	23	10.9	1/4"	Rear
SDG05S18M6	18,000	1.2	0.54	7	180	87.4	23	10.9	6 mm	Rear
SDG05S23	23,000	1.2	0.54	7	180	87.7	23	10.9	1/4"	Rear
SDG05S23M6	23,000	1.2	0.54	7	180	85.1	23	10.9	6 mm	Rear
<b>0.5 hp (0.37 kW) - Lever Throttle - 300 Series Collet</b>										
SDG05S18S	18,000	1.2	0.54	7	180	87.4	23	10.9	1/4"	Rear
SDG05S18M6S	18,000	1.2	0.54	7	180	87.4	23	10.9	6mm	Rear
SDG05S23S	23,000	1.2	0.54	7	180	85.1	23	10.9	1/4"	Rear
SDG05S23M6S	23,000	1.2	0.54	7	180	85.1	23	10.9	6mm	Rear
<b>0.7 hp (0.52 kW) - Lever Throttle - 200 Series Collet</b>										
SDG7S18F	18,000	1.2	0.6	6	150	85	25	12	1/4"	Front
SDG7S18M6F	18,000	1.2	0.6	6	150	82	25	12	6mm	Front
SDG7S25F	25,000	1.2	0.6	6	150	82.3	25	12	1/4"	Front
SDG7S25M6F	25,000	1.2	0.6	6	150	82	25	12	6mm	Front
<b>1 hp (0.75 kW) - Lever Throttle - 200 Series Collet</b>										
SDG10S12F	12,000	1.7	0.8	7.5	190	85.1	30	14	1/4"	Front
SDG10S12M6F	12,000	1.7	0.8	7.5	190	78	30	14	6mm	Front
SDG10S12R	12,000	1.7	0.8	7.5	190	84.4	30	14	1/4"	Rear
SDG10S12M6R	12,000	1.7	0.8	7.5	190	78	30	14	6mm	Rear
SDG10S18F	18,000	1.7	0.8	7.5	190	81.5	30	14	1/4"	Front
SDG10S18M6F	18,000	1.7	0.8	7.5	190	78	30	14	6mm	Front
SDG10S18R	18,000	1.7	0.8	7.5	190	76.4	30	14	1/4"	Rear
SDG10S18M6R	18,000	1.7	0.8	7.5	190	78	30	14	6mm	Rear
SDG10S25F	25,000	1.7	0.8	7.5	190	86.8	30	14	1/4"	Front
SDG10S25M6F	25,000	1.7	0.8	7.5	190	78	30	14	6mm	Front
SDG10S25R	25,000	1.7	0.8	7.5	190	83.2	30	14	1/4"	Rear
SDG10S25M6R	25,000	1.7	0.8	7.5	190	78	30	14	6mm	Rear

General:

Air Inlet Size: 1/4" NPT • Recommended Hose Size: 3/8" (10 mm) • Performance rated @ 90 psig (6.2 bar) air pressure

Standard Equipment:

Parts List • Safety and Instruction Manual • Collet & Wrenches

EXTENDED DIE GRINDERS



SXG05S23



STXG10S18

Features:

- Heavy duty double tapered collet
- Ergonomic comfort grip
- Teasing throttle for maximum control
- Lever throttle with lock-off
- Ball bearing construction
- Adjustable speed control

Extended Die Grinders



Model Number	Free Speed	Weight		Length		Sound Level	Air Consumption		Collet Size	Exhaust
	rpm	lb	kg	in	mm	dB(A)	cfm	l/s		
<b>0.5 hp (0.37 kW) - Lever Throttle - Extended - 200 Series Collet</b>										
SXG05S18	18,000	2.1	0.95	11	280	85.8	23	10.9	1/4"	Rear
SXG05S18M6	18,000	2.1	0.95	11	280	86.7	23	10.9	6 mm	Rear
SXG05S23	23,000	2.1	0.95	11	280	89.8	23	10.9	1/4"	Rear
SXG05S23M6	23,000	2.1	0.95	11	280	85.9	23	10.9	6 mm	Rear
<b>0.5 hp (0.37 kW) - Extended Die Grinder Lever Throttle - 300 Series Collet</b>										
SXG05S18S	18,000	2.1	0.95	11	280	86.7	23	10.9	1/4"	Rear
SXG05S18M6S	18,000	2.1	0.95	11	280	86.7	23	10.9	6mm	Rear
SXG05S23S	23,000	2.1	0.95	11	280	85.9	23	10.9	1/4"	Rear
SXG05S23M6S	23,000	2.1	0.95	11	280	85.9	23	10.9	6mm	Rear
<b>1 hp (0.75 kW) - Lever Throttle - Extended - 200 Series Collet</b>										
STXG10S12	12,000	2.65	1.20	12.10	308	84.5	30	14.2	1/4"	Rear
STXG10S12M6	12,000	2.65	1.20	12.10	308	78	30	14.2	6mm	Rear
STXG10S18	18,000	2.65	1.20	12.10	308	82	30	14.2	1/4"	Rear
STXG10S18M6	18,000	2.65	1.20	12.10	308	78	30	14.2	6mm	Rear
STXG10S23	23,000	2.65	1.20	12.10	308	78	30	14.2	1/4"	Rear
STXG10S23M6	23,000	2.65	1.20	12.10	308	81.6	30	14.2	6mm	Rear

General:

Air Inlet Size: 1/4" NPT • Recommended Hose Size: 3/8" (10 mm) • Performance rated @ 90 psig (6.2 bar) air pressure

Standard Equipment:

Parts List • Safety and Instruction Manual • Collet & Wrenches



RIGHT ANGLE DIE GRINDERS



Features:

- Powerful 5 vane motors deliver high working speeds
- Heavy duty double tapered collet
- Teasing throttle for maximum control
- Lever throttle with lock-off
- Ball bearing construction
- Heavy Duty spiral bevel gearing for durability and smooth operation
- Compact angle head allows access into tight spaces
- Adjustable speed control
- Grease zerk in gear case

Right Angle Die Grinders



Model Number	Free Speed		Weight		Length		Sound Level dB(A)	Air Consumption Free Speed		Collet Size	Exhaust
	rpm		lb	kg	in	mm		cfm	l/s		
<b>0.3 hp (0.22 kW) - Lever Throttle - 200 Series Collet</b>											
SAG03S12	12,000		1.2	0.55	5.625	140	81.5	11	5.2	1/4"	Rear
SAG03S12M6	12,000		1.2	0.55	5.625	140	82.3	11	5.2	6 mm	Rear
SAG03S20	20,000		1.2	0.55	5.625	140	86.4	11	5.2	1/4"	Rear
SAG03S20M6	20,000		1.2	0.55	5.625	140	85.9	11	5.2	6 mm	Rear
<b>0.3 hp (0.22 kW) - Lever Throttle - 300 Series Collet</b>											
SAG03S12S	12,000		1.15	0.52	5.625	143	82.3	11	5.2	1/4"	Rear
SAG03S12M6S	12,000		1.15	0.52	5.625	143	82.3	11	5.2	6mm	Rear
SAG03S20S	20,000		1.15	0.52	5.625	143	85.9	11	5.2	1/4"	Rear
SAG03S20M6S	20,000		1.15	0.52	5.625	143	85.9	11	5.2	6mm	Rear
<b>0.5 hp (0.37 kW) - Lever Throttle - 200 Series Collet</b>											
SAG05S23	23,000		1.4	0.64	6.375	160	86	23	10.8	1/4"	Rear
SAG05S23M6	23,000		1.4	0.64	6.375	160	86	23	10.8	6 mm	Rear
<b>0.5 hp (0.37 kW) - Lever Throttle - 300 Series Collet</b>											
SAG05S23S	23,000		1.35	0.61	6.375	162	89.1	23	10.8	1/4"	Rear
SAG05S23M6S	23,000		1.35	0.61	6.375	162	86	23	10.8	6mm	Rear
<b>0.70 hp (0.52 kW) - Lever Throttle - 200 Series Collet</b>											
SAG7S12	12,000		2.00	0.90	6.500	165	84.3	25	12	1/4"	Front
SAG7S12M6	12,000		2.00	0.90	6.500	165	84.3	25	12	6mm	Front
SAG7S15	15,000		2.00	0.90	6.500	165	85.3	25	12	1/4"	Front
SAG7S15M6	15,000		2.00	0.90	6.500	165	85.3	25	12	6mm	Front
SAG7S18	18,000		2.00	0.90	6.500	165	85	25	12	1/4"	Front
SAG7S18M6	18,000		2.00	0.90	6.500	165	85	25	12	6mm	Front
<b>1 hp (0.75 kW) - Lever Throttle - 200 Series Collet</b>											
SAG10S12	12,000		2.7	1.2	7.5	190	87.4	30	14	1/4"	Rear
SAG10S12M6	12,000		2.7	1.2	7.5	190	78	30	14	6 mm	Rear
SAG10S15	15,000		2.7	1.2	7.5	190	84.2	30	14	1/4"	Rear
SAG10S15M6	15,000		2.7	1.2	7.5	190	78	30	14	6 mm	Rear
SAG10S18	18,000		2.7	1.2	7.5	190	83.2	30	14	1/4"	Rear
SAG10S18M6	18,000		2.7	1.2	7.5	190	78	30	14	6 mm	Rear

General:

Air Inlet Size: 1/4" NPT • Recommended Hose Size: 3/8" (10 mm) • Performance rated @ 90 psig (6.2 bar) air pressure

Standard Equipment:

Parts List • Safety and Instruction Manual • Collet, Support Handle (1 HP only) & Wrenches



RIGHT ANGLE DIE GRINDERS



SAG10AX12

**Features:**

- Powerful 5 vane motors deliver high working speeds
- Heavy duty double tapered collet
- Teasing throttle for maximum control
- Lever throttle with lock-off
- Ball bearing construction
- Heavy Duty spiral bevel gearing for durability and smooth operation
- Compact angle head allows access into tight spaces
- Adjustable speed control
- Grease zerk in gear case

**Right Angle Die Grinders**



Model Number	Free Speed	Weight		Length		Sound Level	Air Consumption		Collet Size	Exhaust
	rpm	lb	kg	in	mm	dB(A)	cfm	l/s		
<b>1 hp (0.75 kW) - Lever Throttle - 200 Series Collet</b>										
SAG10AX12	12,000	3.20	1.45	11.25	286	81.6	30	14.2	1/4"	Rear
SAG10AX12M6	12,000	3.20	1.45	11.25	286	79.5	30	14.2	6mm	Rear
SAG10AX15	15,000	3.20	1.45	11.25	286	81.6	30	14.2	1/4"	Rear
SAG10AX15M6	15,000	3.20	1.45	11.25	286	84	30	14.2	6mm	Rear
SAG10AX18	18,000	3.20	1.45	11.25	286	83.7	30	14.2	1/4"	Rear
SAG10AX18M6	18,000	3.20	1.45	11.25	286	80.5	30	14.2	6mm	Rear

**General:**

Air Inlet Size: 1/4" NPT • Recommended Hose Size: 3/8" (10 mm) • Performance rated @ 90 psig (6.2 bar) air pressure

**Standard Equipment:**

Parts List • Safety and Instruction Manual • Collet, Support Handle (1 HP only) & Wrenches



HIGH TORQUE DIE GRINDERS

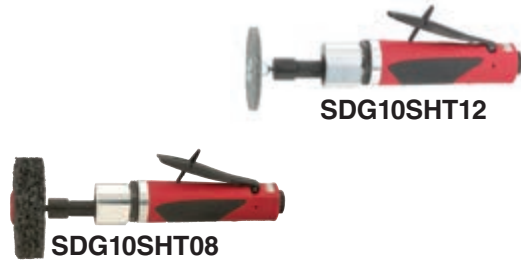
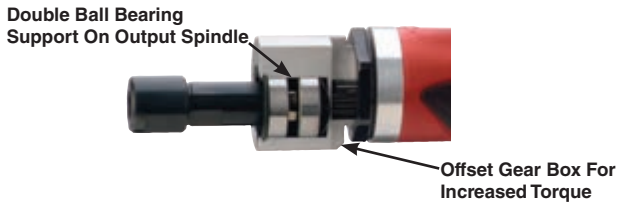

High Torque Die Grinders

CE

Model Number	Free Speed	Weight		Length		Sound Level	Air Consumption		Collet Size	Exhaust
	rpm	lb	kg	in	mm	dB(A)	cfm	l/s		
<b>1 hp (0.75 kW) - Lever Throttle - High Torque - 200 Series Collet</b>										
SDG10SHT08	8,000	2	0.90	9.5	240	85.1	35	16.5	1/4"	Rear
SDG10SHT08M6	8,000	2	0.90	9.5	240	85.6	35	16.5	6 mm	Rear
SDG10SHT12	12,000	2	0.90	9.5	240	81.8	35	16.5	1/4"	Rear
SDG10SHT12M6	12,000	2	0.90	9.5	240	84	35	16.5	6 mm	Rear

General:

Air Inlet Size: 1/4" NPT • Recommended Hose Size: 3/8" (10 mm) • Performance rated @ 90 psig (6.2 bar) air pressure

Standard Equipment:

Parts List • Safety and Instruction Manual • Collet & Wrenches



**200 SERIES**  
Heavy Duty Double Tapered Collet  
Collet Nut    Collet    Collet Body



Part Number	Description
<b>Collet Sizes</b>	
74071	Collet Nut
74072	Collet (1/8")
74073	Collet (3/16")
74074	Collet (1/4")
68030	Collet (3/8")
74075	Collet (3 mm)
74076	Collet (6 mm)
68056	Collet (8 mm)
77057	Collet Body SDG Series
74070	Collet Body (1 hp)

**300 SERIES**  
Heavy Duty Double Tapered Collet  
Collet Nut    Collet    Collet Body



Part Number	Description
<b>Collet Sizes</b>	
74128	Collet Nut
74124	Collet (3/32")
74121	Collet (1/8")
74120	Collet (1/4")
74122	Collet (3 mm)
74123	Collet (6 mm)
77505	Collet Body SAS Series
74125	Collet Body SDG Series

Sioux-per Swivel



Part Number	Description
1338-25	1/4" non-regulated air swivel connector with safety pin
1338-38	3/8" non-regulated air swivel connector with safety pin
1338-50	1/2" non-regulated air swivel connector with safety pin
1338FC-25	1/4" regulated air swivel connector with safety pin



RIGHT ANGLE TYPE 27 WHEEL GRINDERS



**Features:**

- Full 1 hp, 5 vane air motor maintains power under load
- Ergonomic comfort grip
- Ball bearing construction
- Teasing throttle for maximum control
- Rotatable guard
- 4 position indexable angle head
- Lever throttle with lock-off
- Grease zerk in gear case

**Right Angle Type 27 Wheel Grinders**

CE

Model Number	Free Speed	Wheel Capacity		Weight		Length		Sound Level dB(A)	Air Consumption Free Speed		Spindle Thread	Exhaust
	rpm	in	mm	lb	kg	in	mm		cfm	l/s		
<b>1 hp (0.75 kW) - Lockoff Lever Throttle</b>												
SWG10S124	12,000	4	100	3	1.6	8.3	210	77	35	17	3/8" - 24	Rear
SWG10S1245	12,000	4.5	115	3	1.6	8.3	210	77	35	17	5/8" - 11	Rear
SWG10A124	12,000	4	100	2.5	1.1	7.75	195	86.4	35	17	3/8" - 24	Rear
SWG10A1245	12,000	4.5	115	2.6	1.17	7.75	195	84.9	35	17	5/8"-11	Rear
SWG10A125	12,000	5	127	2.7	1.22	7.75	195	83.7	35	17	5/8" - 11	Rear
SWG10S183	18,000	3	75	2.5	1.1	7.5	190	77	35	17	3/8 - 24	Rear

**General:**

Air Inlet Size: 3/8" NPT • Recommended Hose Size: 3/8" (10 mm) • Performance rated @ 90 psig (6.2 bar) air pressure

**Standard Equipment:**

Parts List • Safety and Instruction Manual • Spindle Wrenches • Wheel Guard • Support Handle • Mounting Flange & Nut

**Right Angle Type 27 Extended Wheel Grinders**

CE

Model Number	Free Speed	Wheel Capacity		Weight		Length		Sound Level dB(A)	Air Consumption Free Speed		Spindle Thread	Exhaust
	rpm	in	mm	lb	kg	in	mm		cfm	l/s		
<b>1 hp (0.75 kW) - Lockoff Lever Throttle</b>												
SWG10AX124	12,000	4	100	3.6	1.63	11.25	285	91	35	17	3/8" - 24	Rear
SWG10AX1245	12,000	4.5	115	3.7	1.68	11.25	285	86	35	17	5/8" - 11	Rear
SWG10AX125	12,000	5	127	3.8	1.72	11.25	285	83.7	35	17	5/8" - 11	Rear

**General:**

Air Inlet Size: 3/8" NPT • Recommended Hose Size: 3/8" (10 mm) • Performance rated @ 90 psig (6.2 bar) air pressure

**Standard Equipment:**

Parts List • Safety and Instruction Manual • Spindle Wrenches • Wheel Guard • Support Handle • Mounting Flange & Nut



CUTOFF TOOLS (TYPE 1)



SCO10S253F



SCO10S204R

Features:

- Full 1 hp air motor maintains power under load
- Aluminum reinforced housing with comfort grip
- Ball bearing construction
- Teasing throttle for maximum control
- 360 degree rotatable guard
- Adjustable speed control

Panel and Cutoff Saw



Model Number	Blade Diameter		Depth of Cut		Free Speed rpm	Weight		Length		Air Consumption		Sound Level dB(A)	Exhaust
	in	mm	in	mm		lb	kg	in	mm	cfm	l/s		
<b>1 hp (0.75 kW) - Cutoff Saw - Inline - Lockoff lever Start</b>													
SCO10S184F	4	100	1.1	28	18,000	2	0.9	8.3	210	30	14	89.1	Front
SCO10S184R	4	100	1.1	28	18,000	2	0.9	8.3	210	30	14	87.8	Rear
SCO10S204F	4	100	1.1	28	20,000	2	0.9	8.3	210	30	14	90.3	Front
SCO10S204R	4	100	1.1	28	20,000	2	0.9	8.3	210	30	14	91.6	Rear
SCO10S253F	3	76	1	25	25,000	2	0.9	8.3	210	30	14	89	Front
SCO10S253R	3	76	1	25	25,000	2	0.9	8.3	210	30	14	87.8	Rear

General:

Air Inlet Size: 1/4" NPT • Recommended Hose Size: 3/8" (10 mm) • Performance rated @ 90 psig (6.2 bar) air pressure

Standard Equipment:

Parts List • Safety and Instruction Manual • 1 Blade • Spindle Wrenches & Guard

ANGLE CUTOFF TOOLS (TYPE 1)

Features:

- Heavy duty spiral bevel gearing for durability and smooth operation
- 4 position indexable angle head
- 360 degree rotatable guard
- Grease zerk in gear case



SCO10A106

Angle Cutoff Tool



Model Number	Blade Diameter		Depth of Cut		Free Speed rpm	Weight		Length		Air Consumption		Sound Level dB(A)	Spindle Thread	Exhaust
	in	mm	in	mm		lb	kg	in	mm	cfm	l/s			
SCO10A106	6	150	2	51	10,000	3.7	1.7	8.75	220	35	16.5	91.2	5/8"-11	Rear
SCO10A125	5	125	1.5	38	12,000	3.5	1.6	8.75	220	35	16.5	87.3	5/8"-11	Rear

General:

Air Inlet Size: 3/8" NPT • Recommended Hose Size: 3/8" (10 mm) • Performance rated @ 90 psig (6.2 bar) air pressure

Standard Equipment:

Parts List • Safety and Instruction Manual • 1 Blade • Spindle Wrenches & Guard



Heavy Duty Spiral Bevel Gears

RIGHT ANGLE AND VERTICAL SANDERS



SAS10S125



SAS10AX125



SAS10A125



1290L

**Features:**

- Lock-off Lever
- Side Exhaust on 1290 series
- Rear Exhaust on SAS Series

**Right Angle and Vertical Sanders**



Model Number	Free Speed	Pad Diameter		Weight		Length		Air Consumption Free Speed		Sound Level	Spindle Thread
	rpm	in	mm	lb	kg	in	mm	cfm	l/s	dB(A)	
<b>Right Angle Sanders</b>											
<b>1 hp (0.75 kW) - Lock-off Lever Throttle - Rear Exhaust</b>											
SAS10S125	12,000	5	125	3.5	1.6	8.3	210	35	17	77	3/8"-24
SAS10A125	12,000	5	125	2.2	1	7.75	134	35	17	84.1	5/8"-11
SAS10AX125	12,000	5	125	3.2	1.45	11.25	285	35	17	83.2	5/8"-11
<b>Vertical Sanders</b>											
<b>1 hp (0.75 kW) - Thumb Throttle</b>											
1290 <sup>1</sup>	6000	7	175	4.1	1.9	7.2	183	38	18	80	5/8"-11
<b>1 hp (0.75 kW) - Lever Throttle</b>											
1290L <sup>1</sup>	6000	7	175	4.1	1.9	7.2	183	38	18	80	5/8"-11

<sup>1</sup>Not CE certified

**General:**

Air Inlet Size: 1/4" NPT 1290 Series, 3/8" NPT SAS Series • Recommended Hose Size: 3/8" (10 mm) • Performance rated @ 90 psig (6.2 bar) air pressure

**Standard Equipment:**

Parts List • Safety and Instruction Manual • Support Handle • Spindle Wrenches • Backing Pad & Nut



77016 Threaded Arbor



300 Series Collet



SAS03S122-20



SAS05S232-20



SAS10A182-20

**Right Angle Disc Sanders**



Model Number	Free Speed	Weight		Length		Air Consumption Free Speed		Sound Level	Spindle Thread
	rpm	lb	kg	in	mm	cfm	l/s	dB(A)	
<b>0.3 hp (0.22 kW) - Lever Throttle</b>									
SAS03S122-20	12,000	1.1	0.5	5.625	143	11	5.2	82.2	1/4"-20
SAS03S202-20	20,000	1.1	0.5	5.625	143	11	5.2	82.9	1/4"-20
<b>0.5 hp (0.37 kW) - Lever Throttle</b>									
SAS05S232-20	23,000	1.3	0.59	5.625	143	23	10.3	88.6	1/4"-20
<b>1 hp (0.75 kW) - Lever Throttle</b>									
SAS10A122-20	12,000	2.15	0.98	7.5	190	30	14	84.6	1/4"-20
SAS10A152-20	15,000	2.15	0.98	7.5	190	30	14	TBD	1/4"-20
SAS10A182-20	18,000	2.15	0.98	7.5	190	30	14	83.4	1/4"-20

**General:**

Air Inlet Size: 1/4" NPT • Recommended Hose Size: 3/8" (10 mm) • Performance rated @ 90 psig (6.2 bar) air pressure

**Standard Equipment:**

Parts List • Safety and Instruction Manual • Support Handle (1 hp Models) • Spindle Wrenches, 300 Series Collet, 1/4"-20 Threaded Arbor

**PISTOL GRIP SANDERS**



**SPS10P18**



**SDG10P18**



**Features:**

- Trigger Start
- Down-Handle Exhaust
- Comfort Grip

**Pistol Grip Sanders**

Model Number	Free Speed		Weight		Height		Air Consumption Free Speed		Sound Level
	rpm		lb	kg	in	mm	scfm	l/s	dB(A)
<b>1 hp (0.75 kW) - 5" (125 mm) Diameter Backing Pad</b>									
SPS10P18	18,000		1.7	0.8	4.5	115	35	17	80
<b>1 hp (0.75 kW) - 1/4" Collet</b>									
SDG10P18	18,000		1.7	0.8	5.8	145	35	17	80
SDG10P21	21,000		1.7	0.8	5.8	145	35	17	80

**General:**

Air Inlet Size: 1/4" NPT • Recommended Hose Size: 3/8" (10 mm) • Performance rated @ 90 psig (6.2 bar) air pressure

**Standard Equipment:**

Parts List • Safety and Instruction Manual • Comfort Grip

**RIGHT ANGLE AND VERTICAL SANDERS**



**1287L**



**VS20AL-727**



**Features:**

- Governed
- Lever & Thumb Throttle
- Side Exhaust

**What are the benefits of a Governed Motor?**

- Governed motors maintain maximum working RPMs and provide more power at higher speed.
- Governed motors require less air and control the speed of the wheel, preventing overspeed.

- Improved productivity and enhanced operator safety.
- Increased abrasive efficiency and improved service life of consumables.
- Result? Reduced cost.

**What does the user gain?**

**Governed Sanders**

Model Number	Free Speed		Pad Diameter		Weight		Length		Air Consumption Under Load		Air Consumption Free Speed		Sound Level	Spindle Thread
	rpm		in	mm	lb	kg	in	mm	cfm	l/s	cfm	l/s	dB(A)	
<b>1 hp (0.75 kW) - Governed Speed Control - Lock-off Lever Throttle</b>														
1287L <sup>1</sup>	6000		7	175	5.9	2.7	11.3	287	35	17	18	8	85	5/8"-11
<b>2 hp (1.5 kW) Class Vertical Sanders - Governed Speed Control - Lock-off Lever Throttle</b>														
VS20AL-609 <sup>2</sup>	6000		9	230	7.4	3.3	5.5	145	75	35	26	12	85	5/8"-11
VS20AL-727 <sup>2</sup>	7200		7	175	7.4	3.3	5.5	145	75	35	26	12	85	5/8"-11

**General:**

<sup>1</sup>Air Inlet Size: 1/4" NPT • Recommended Hose Size: 3/8" (10 mm) • Performance rated @ 90 psig (6.2 bar) air pressure

<sup>2</sup>Air Inlet Size: 1/2" NPT • Recommended Hose Size: 1/2" (13 mm) • Performance rated @ 90 psig (6.2 bar) air pressure

**Standard Equipment:**

Parts List • Safety and Instruction Manual • Support Handle • Spindle Wrenches • Backing Pad & Nut

VERTICAL TYPE 27 WHEEL GRINDERS



**Features:**

- Lever & Thumb Throttle
- Side Exhaust

**Vertical Type 27 Wheel Grinders**

Model Number	Free Speed	Wheel Capacity		Weight		Length		Sound Level dB(A)	Air Consumption Free Speed		Spindle Thread	
	rpm	in	mm	lb	kg	in	mm		cfm	l/s		
<b>1 hp (0.75 kW) - Non-Governer Speed - Lever Throttle</b>												
1291L	6000	7	175	5	2.3	7.2	183	80	38	18	5/8"-11	
<b>1 hp (0.75 kW) - Non-Governer Speed - Thumb Throttle</b>												
1291	6000	7	175	5	2.3	7.2	183	80	38	18	5/8"-11	

**General:**

Air Inlet Size: 1/4" NPT • Recommended Hose Size: 3/8" (10 mm) • Performance rated @ 90 psig (6.2 bar) air pressure

**Standard Equipment:**

Parts List • Safety and Instruction Manual • Spindle Wrenches • Wheel Guard • Support Handle • Mounting Flange & Nut

**VERTICAL GOVERNED  
TYPE 27 WHEEL GRINDER**



VG20AL-60D7

**VERTICAL GOVERNED  
TYPE 6 & 11 WHEEL GRINDERS**



VG30AL-60C6

**Features:**

- Lock-off Lever & Thumb Throttle
- Side Exhaust

**What are the benefits of a Governed Motor?**

- Governed motors maintain maximum working RPMs and provide more power at higher speed.
- Governed motors require less air and control the speed of the wheel, preventing overspeed.

**What does the user gain?**

- Improved productivity and enhanced operator safety.
- Increased abrasive efficiency and improved service life of consumables.
- Result? Reduced cost.



**Governed Grinders**

Model Number	Free Speed	Wheel Capacity		Weight		Length		Sound Level dB(A)	Air Consumption Under Load		Air Consumption Free Speed		Spindle Thread
	rpm	in	mm	lb	kg	in	mm		cfm	l/s	cfm	l/s	
<b>Vertical Type 27 Wheel Grinders</b>													
<b>2 hp (1.5 kW) - Class Vertical Grinders - Governed Speed - Lever Throttle</b>													
VG20AL-45D9	4500	9	230	7.4	3.3	5.5	145	85	75	35	26	12	5/8"-11
VG20AL-60D7	6000	7	175	7.4	3.3	5.5	145	85	75	35	26	12	5/8"-11
VG20AL-60D9	6000	9	230	7.4	3.3	5.5	145	85	75	35	26	12	5/8"-11
<b>3 hp (2.2 kW) - Class Vertical Grinders - Governed Speed - Lever Throttle</b>													
VG30AL-45D7	4500	7	175	9.5	4.3	6.4	165	84	90	42	39	18	5/8"-11
VG30AL-45D9	4500	9	230	9.5	4.3	6.4	165	84	90	42	39	18	5/8"-11
VG30AL-60D7	6000	7	175	9.5	4.3	6.4	165	84	90	42	39	18	5/8"-11
VG30AL-60D9	6000	9	230	9.5	4.3	6.4	165	84	90	42	39	18	5/8"-11
<b>Vertical Type 6 &amp; 11 Wheel Grinders</b>													
<b>2 hp (1.5 kW) - Class Vertical Grinders - Governed Speed - Lever Throttle</b>													
VG20AL-60C6	6000	6	150	7.4	3.3	5.5	145	85	75	35	26	12	5/8"-11
<b>3 hp (2.2 kW) - Class Vertical Grinders - Governed Speed - Lever Throttle</b>													
VG30AL-60C6	6000	6	150	9.5	4.3	6.4	165	84	90	42	39	18	5/8"-11

**General:**

Air Inlet Size: 1/2" NPT • Recommended Hose Size: 1/2" (13 mm) • Performance rated @ 90 psig (6.2 bar) air pressure

**Standard Equipment:**

Parts List • Safety and Instruction Manual • Spindle Wrenches • Wheel Guard • Support Handle • Mounting Flange & Nut

**RIGHT ANGLE TYPE 27 WHEEL GRINDER**



1285L

**Features:**

- Lock-off Lever & Thumb Throttle
- Side Exhaust

**What are the benefits of a Governed Motor?**

- Governed motors maintain maximum working RPMs and provide more power at higher speed.
- Governed motors require less air and control the speed of the wheel, preventing overspeed.

**HORIZONTAL GRINDERS**



HG20AL-80P3



HG30AL-60S6

**What does the user gain?**

- Improved productivity and enhanced operator safety.
- Increased abrasive efficiency and improved service life of consumables.
- Result? Reduced cost.

**Governed Grinders**

Model Number	Free Speed	Wheel Capacity		Weight		Length		Sound Level	Air Consumption Under Load		Air Consumption Free Speed		Spindle Thread	
	rpm	in	mm	lb	kg	in	mm	dB(A)	cfm	l/s	cfm	l/s		
<b>Right Angle Type 27 Wheel Grinders</b>														
<b>1 hp (0.75 kW) - Governed Speed - Lock-off Lever Throttle</b>														
1285L <sup>1</sup>	6000	7	175	5.9	2.7	12.4	315	85	35	17	18	8	5/8"-11	
<b>Horizontal Wheel Grinders</b>														
<b>2 hp (1.5 kW) - Class Horizontal Grinders - Governed Speed - Lever Throttle</b>														
HG20AL-45S8 <sup>2</sup>	4500	8	200	10.5	4.8	20.8	530	85	75	35	26	12	5/8"-11	
HG20AL-60S6 <sup>2</sup>	6000	6	150	10.5	4.8	20.8	530	85	75	35	26	12	5/8"-11	
HG20AL-80P3 <sup>2</sup>	8000	3	75	10.5	4.8	20.8	530	85	75	35	26	12	5/8"-11	
<b>3 hp (2.2 kW) - Class Horizontal Grinders - Governed Speed - Lever Throttle</b>														
HG30AL-45S8 <sup>2</sup>	4500	8	200	12.5	5.6	21.8	550	84	90	42	39	18	5/8"-11	
HG30AL-60S6 <sup>2</sup>	6000	6	150	12.5	5.6	21.8	550	84	90	42	39	18	5/8"-11	
HG30AL-80P3 <sup>2</sup>	8000	3	75	12.5	5.6	21.8	550	84	90	42	39	18	5/8"-11	

**General:**

<sup>1</sup>Air Inlet Size: 1/4" NPT • Recommended Hose Size: 3/8" (10 mm) • Performance rated @ 90 psig (6.2 bar) air pressure  
<sup>2</sup>Air Inlet Size: 1/2" NPT • Recommended Hose Size: 1/2" (13 mm) • Performance rated @ 90 psig (6.2 bar) air pressure

**Standard Equipment:**

Parts List • Safety and Instruction Manual • Spindle Wrenches • Wheel Guard • Support Handle • Mounting Flange & Nut



# A Complete Metal Working Tool Program to Handle Any Application

	0.3 hp	0.5 hp	0.7 hp	1.0 hp	High Torque, Low RPM
<b>Industrial Die Grinders</b>					
• Straight					
• Angle					
• Extended					
• High Torque					

	3" & 4" Type 1	5" & 6" Type 1	3" & 4" Type 27	4-1/2" Type 27	4-1/2" Type 27
<b>Industrial</b>					
• Cutoff Tools					
• Sanders					
• Angle Wheel Grinders					

	1.0 hp		
<b>Governed Right Angle</b>			
• Wheel Grinders			
• Sanders			
• Polishers			

	1.0 hp			2.0 HP & 3.0 hp		
<b>Vertical</b>						
• Grinders						
• Sanders						
• Polishers						

	2.0 hp		3.0 hp	
<b>Horizontal</b>				
• Grinders				

**Abrasive Safety**

Grinders can cause flying particles. Proper eye protection must be worn at all times by tools user and bystanders.

Under improper use and wear, Air Grinders can cause serious injury and death. The following instructions are important and should be followed explicitly but cannot cover all contingencies. Good judgment is always required.

Using a Grinder without a guard can cause injury. The grinder is to be operated with an appropriate guard at all times when a grinding wheel is used. Replace a damaged guard. The guard is to be the proper one for the wheel being used.

Damaged Grinding Wheels can explode. Check the wheel for damage before mounting, such as chips and cracks. Handle wheels carefully to avoid dropping or bumping. Protect wheels from extremes of temperature and humidity. Check wheels immediately after any unusual occurrence that may damage wheels.

Over Speeding Wheels can explode. Check the speed rating of the accessory or the speed printed on the wheel. This speed must be greater than the name plate speed of the grinder / sander and the actual speed of the grinder / sander as measured with a tachometer.

Unsecured work can move violently when grinding. Secure work; use clamps or vise to hold work.

Grinders may coast for a short time after the trigger is released. Be sure tool has come to a complete stop before setting it aside.

Grinding wheels that malfunction or spin off can cause injury. Be certain that all wheels, flanges, nuts and related equipment are in good shape, the proper ones for the type and size of wheel being used, and are securely fastened.

Exploding wheels can cause injury or death. If the normal sound of the grinder changes, or if it vibrates excessively, shut it off immediately, remove the wheel, and check speed with tachometer.

Unexpected starts can cause injury. Be sure actuator is off before hooking up air.

Breathing grinding dust can cause injury. Do not breathe grinding dust. Use approved mask.

Explosions and fire can cause injury. Only grind metals if the area is free of combustible or explosive materials or vapors.

Contact with rotating grinding wheels can cause injury. Keep hands and other body parts away from grinding wheels and sanding pads and disks to prevent cutting or pinching. Wear protective clothing and gloves to protect hands.

Tools starting unexpectedly can cause injury. Always remove tool from air supply and activate trigger to bleed air line before making any adjustments, changing accessories, or doing any maintenance or service on the tool.

Flying grinding wheels or accessories can cause injury. Tighten collet securely. Match wheel or accessory shaft diameter to chuck or collet.

Exploding or flying parts can cause injury. Do not use cutoff wheels or router bits with die grinders.



Distributed By:

Dobco Equipment Limited  
1-2430 Lucknow Drive,  
Mississauga, Ontario  
L5S 1V3 Canada  
  
905.672.5557  
  
sales@dobcoeqp.com

www.dobcoeqp.com sales@dobcoeqp.com 905-672-5557 DOBCO EQUIPMENT LTD.

DOBCO EQUIPMENT LTD. 905-672-5557 sales@dobcoeqp.com www.dobcoeqp.com