

Finishing

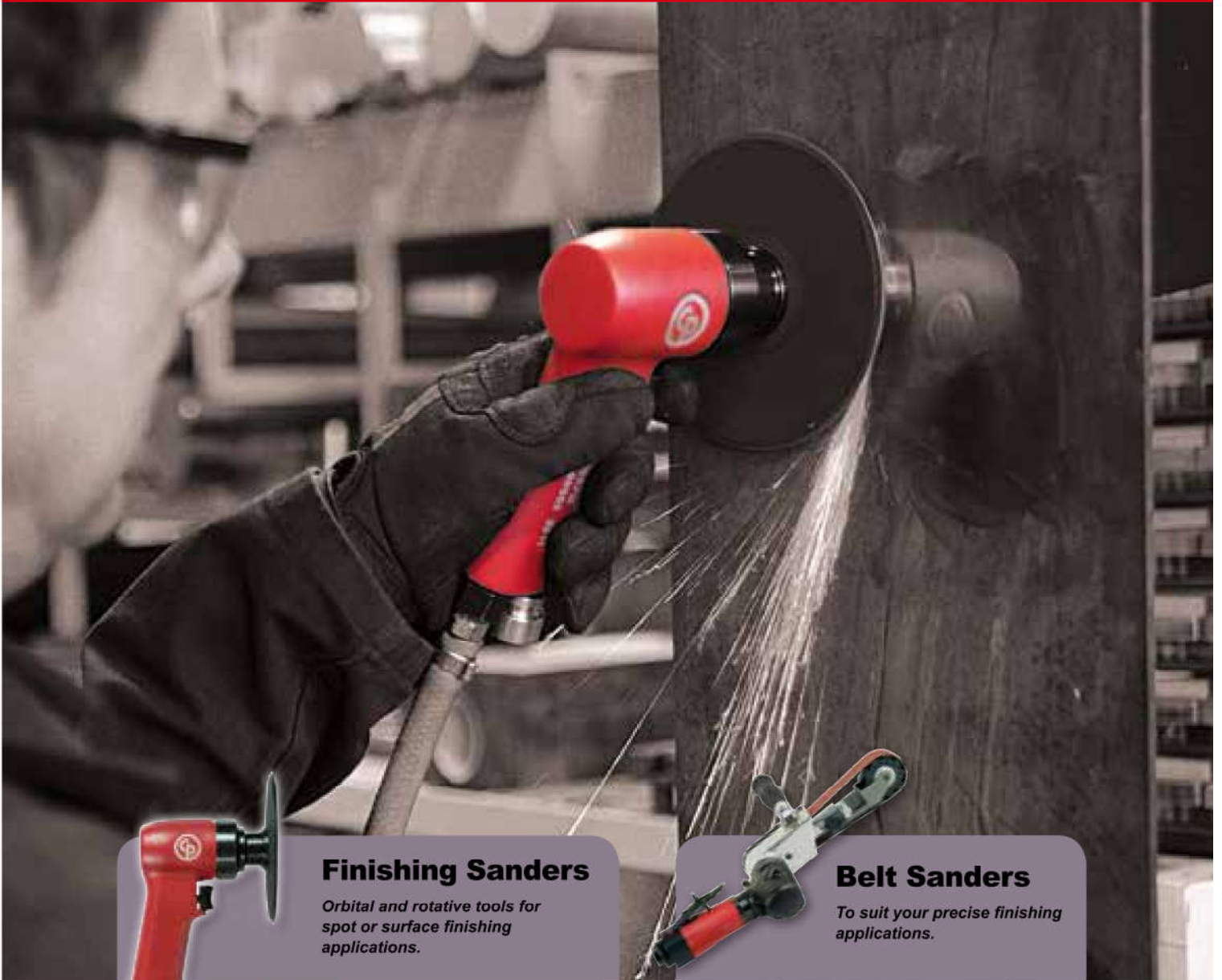

Finishing Sanders

Orbital and rotative tools for spot or surface finishing applications.

Belt Sanders

To suit your precise finishing applications.

How to select your finishing tool?

Step 1

Applications

- ▶ Material type
- ▶ Treatment type
- ▶ Finishing type
- ▶ Intensity

Step 2

Abrasives

- ▶ Shape
- ▶ Grit size
- ▶ Process
- ▶ Rotation type
- ▶ Access

Step 3

Tools

- ▶ Handling shape
- ▶ Pad / Belt size
- ▶ Speed

Finishing

CP7202

ROTARY SANDING

FEATURES

- Mini pistol disc sander with 3" (75 mm) Roloc pad
- Rubber molded pistol grip
- Adjustable power regulator
- 2-fingered throttle
- Handle exhaust

BENEFITS

- General Maintenance Applications pistol sander
- Compact & lightweight
- Maximize operator control and ergonomics, less fatigue
- Job done faster and easier
- Excellent for small area repair



CP7202



CP7202D Kit

Part No. 8941172021

Kit includes:

- (1) CP7202D, Mini disc sander
- (1) 3" (75mm) backing pad
- (10) 3" (75mm) 80, 100, and 120 grit sandings discs
- (1) 3" (75mm) fine, medium and coarse surface prep discs and spindle wrench packed in a heavy duty carrying case



See accessories on pages 101 to 104

CP3030-325AFR



LIGHTWEIGHT & ERGONOMIC

FEATURES

- 2" (50 mm) roloc plate capacity
- 0.4 hp (300 W) industrial grade motor
- 25,000 rpm free speed
- Compact composite handle
- Streamlined safety lever
- Gearless durable construction
- 7° angle to allow working in tight angles
- Rear exhaust

BENEFITS

- Industrial Maintenance and Production angle sander
- Ergonomic handle and high speed
- High durability thanks to simple and robust design
- Ideal for versatile sanding applications



CP3030-325AFR

MODEL	PART NUMBER	FREE SPEED		POWER		PAD CAPACITY		PAPER SIZE		SPINDLE THREAD	AIR CONS. AT FREE SPEED		AIR CONS. @LOAD		NET WEIGHT		LENGTH		VIBRATION LEVEL ISO 28927 (M/S ²)		SOUND PRESS. ISO 15744 - dB(A)	SOUND POWER	AIR INLET
		rpm	hp	W	in.	mm	in.	mm	in		cfm	l/s	cfm	l/s	lb	kg	in.	mm	a	k			
CP7202	894 107 2021	15,000	0.2	150	3	75	3	75	3	75	1/4-20 UNC	21	9	21.0	9.9	1.5	0.6	4	120	<2.5	84	95.8	1/4"
CP3030-325AFR	615 162 0060	25,000	0.4	300	2	50	2	50	2	50	1/4-20	21	10	14.2	6.7	1.8	0.8	6	154	<2.5	79	90.8	1/4"

All models: Hose int. 3/8" (9.5mm) - @90 PSI (@6.3 Bar)

Listed specifications are for reference only. Please check documents in each tool.

<0.7 hp (500W) Angle Sanders 2" & 3"

Finishing

DOBCO EQUIPMENT LTD.

905-672-5557

sales@dobcoeqp.com

www.dobcoeqp.com

CP3030-415AFR



LIGHTWEIGHT & ERGONOMIC

CP3030-420AFR

Similar features as CP3030-415AFR with 20,000 rpm.

FEATURES

- 3" (76 mm) roloc plate capacity
- 0.54 hp (400 W) industrial grade motor
- 15 000 rpm free speed
- Compact composite handle
- Streamlined safety lever
- Gearless durable construction
- 7° angle to allow working in tight angles
- Rear exhaust

BENEFITS

- Industrial Maintenance and Production angle sander
- Ergonomic handle and high speed
- High durability thanks to simple and robust design
- Ideal for versatile sanding applications

CP3030-515AFR



LIGHTWEIGHT & ERGONOMIC

FEATURES

- 3" (76 mm) roloc plate capacity
- 0.7 hp (500 W) industrial grade motor
- 15 000 rpm free speed
- Compact composite handle
- Streamlined safety lever
- Gearless durable construction
- 7° angle to allow working in tight angles
- Rear exhaust

BENEFITS

- Industrial Maintenance and Production angle sander
- Ergonomic handle and high speed
- High durability thanks to simple and robust design
- Ideal for versatile sanding applications



See accessories on pages 98 to 104

MODEL	PART NUMBER	FREE SPEED		POWER		PAD CAPACITY		PAPER SIZE		SPINDLE THREAD		AIR CONS. AT FREE SPEED		AIR CONS. @LOAD		NET WEIGHT		LENGTH		VIBRATION LEVEL ISO 28927 (M/S2)		SOUND PRESS. POWER		AIR INLET
		rpm	hp	W	in.	mm	in.	mm	in.	mm	in	cfm	l/s	cfm	l/s	lb	kg	in.	mm	a	k	ISO 15744 - dB(A)		
CP3019-12AF	615 160 7080	12,000	0.5	375	3	75	2	50	1/4-20 UNC	17	8	6.3	3.0	0.2	0.6	6	166	<2.5		77	88.6	1/4"		
CP3019-20AF	615 160 7090	20,000	0.5	375	3	75	2	50	1/4-20 UNC	19	9	12.0	5.7	0.2	0.6	6	166	2.7	1.3	81	92.6	1/4"		
CP3030-415AFR	615 162 0070	15,000	0.54	400	3	75	3	75	3/8-24	21	10	16.3	7.7	1.1	0.5	6	174	<2.5		80	91.2	1/4"		
CP3030-420AFR	615 162 0080	20,000	0.54	400	3	75	3	75	3/8-24	27	12	18.4	8.7	1.8	0.8	6	174	<2.5		76	87.2	1/4"		
CP3030-515AFR	615 162 0100	15,000	0.7	500	3	75	3	75	3/8-24	25	11	20.5	9.7	1.8	0.8	6	174	<2.5		76	87.4	1/4"		

All models: Hose int. 3/8" (9.5mm) - @90 PSI (@6.3 Bar)

Listed specifications are for reference only. Please check documents in each tool.

CP3019-12AF

HIGH PERFORMANCE IN A COMPACT PACKAGE

FEATURES

- 3" (76 mm) roloc plate capacity
- 0.5 hp (375 W) governed motor
- 12,000 rpm free speed
- Compact body
- Insulating composite over housing
- Streamlined safety lever
- Highly durable bevel gear
- Rear exhaust

BENEFITS

- Industrial Maintenance and Production angle sander
- Ergonomic handle and high speed
- Highest durability in demanding applications up to 2,000 hours maintenance intervals
- Ideal for versatile sanding applications



CP3019-20AF

Similar features as CP3019-12AF with 20,000 rpm

Finishing

<0.5 hp (375W) Pistol Sanders 5"

CP3070-120G

DURABLE

FEATURES

- 5" (125 mm) sander
- High power 0.5 hp (375 W)
- Free speed 12,000 rpm
- Low noise
- Low vibrations
- Handle exhaust

BENEFITS

- Industrial Maintenance and Production pistol sander
- High durability
- Ergonomics - Compact & easy handling, ideal for limited space applications



CP3070-120G

CP9778



FAST & PRECISE

FEATURES

- Standard-duty hi-speed sander with 5" (125 mm) pad
- Built-in air regulator and variable speed throttle
- Rugged, energy efficient 0.5 hp (375 W) motor
- Low vibration

BENEFITS

- General Maintenance belt sander
- Excellent for paint removal, smoothing and rust removal in limited space applications



CP3070-120G



See accessories on pages 98 to 104

MODEL	PART NUMBER	FREE SPEED		POWER		PAD CAPACITY		SPINDLE TRHEAD	AIR CONS. AT FREE SPEED		AIR CONS. @LOAD		NET WEIGHT		LENGTH	VIBRATION LEVEL ISO 28927 (M/S ²)		SOUND PRESS.	SOUND POWER	AIR INLET
		rpm	hp	W	in.	mm	in.		cfm	l/s	cfm	l/s	lb	kg		in.	mm			
CP3070-120G	615 162 0090	12,000	0.5	375	5	125	3/8-24	26	12	22.0	10.5	2.2	1.0	6	175	<2,5		84	95	1/4"
CP9778	615 193 9778	14,000	0.5	375	5	125	7/16-20	25	12	21.0	9.9	2.2	1.0	10	297	<2,5		90	101	1/4"

All models: Hose int. 3/8" (9.5mm) - @90 PSI (@6.3 Bar)

Listed specifications are for reference only. Please check documents in each tool.

<0.51 hp (380W) Belt Sanders

CP9779



FLEXIBLE & EASY HANDLING

FEATURES

- 3/8" (10 mm) capacity
- Quick-change belt replacement
- Adjustable sanding arm
- Handle exhaust and swivel air inlet
- Rubber molded grip

BENEFITS

- General Maintenance Applications belt sander
- Operator comfort
- Excellent for paint removal, weld sanding, smoothing and rust removal in tight areas

CP9780



EASY HANDLING & LARGE REMOVAL

FEATURES

- 3/4" (20 mm) capacity
- Quick-change belt replacement
- Adjustable sanding arm
- Handle exhaust and swivel air inlet
- Rubber molded grip

BENEFITS

- General Maintenance Applications belt sander
- Excellent for paint removal, smoothing and rust removal in limited space applications

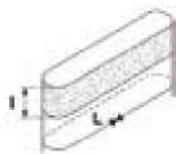

CP858



PRODUCTIVITY & DURABILITY

FEATURES

- Belt sander 3/8" (10 mm) capacity
- Quick change belt replacement
- Adjustable sanding arm
- Handle exhaust

BENEFITS

- General Maintenance belt sander
- Excellent for paint removal, smoothing and rust removal in limited space applications



CP858



CP858

See accessories on pages 98 to 104



MODEL	PART NUMBER	FREE SPEED		POWER		BELT CAPACITY L x W		AIR CONS. AT FREE SPEED		AIR CONS. @LOAD		NET WEIGHT		LENGTH		VIBRATION LEVEL ISO 28927 (M/S ²)		SOUND PRESS. ISO 15744 - dB(A)	SOUND POWER	AIR INLET
		rpm	hp	W	in.	mm	cfm	l/s	cfm	l/s	lb	kg	in.	mm	a	k				
CP858	T025179	18,000	0.4	300	3/8x13	10x330	22	10	22.0	10.4	1.8	0.8	10	275	<2.5	92	103.8	1/4"		
CP9779	615 193 9779	22,000	0.35	260	3/8x13	10x330	13	6	28.0	13.1	1.9	0.9	12	304	<2.5	90	101.5	1/4"		
CP9780	615 193 9780	20,000	0.51	380	3/4x20.4	20x520	14	6	30.0	14.1	3.3	1.5	15	380	<2.5	90	101.5	1/4"		

All models: Hose int. 3/8" (9.5mm) - @90 PSI (@6.3 Bar)

Listed specifications are for reference only. Please check documents in each tool.

Finishing

<0.54 hp (400W) Belt Sanders

CP5080-3260D12

0.4 HP (300 W) BELT SANDER

FEATURES

- 12" (305 mm) belt sander 0.4 hp (300 W)
- Sanding head pivots 360° for multi position sanding
- Easy change of abrasives and contact arm

BENEFITS

- Industrial Maintenance and Production Applications belt sander
- Ergonomic handle and high speed
- High durability thanks to simple and robust design
- Ideal for versatile sanding applications



CP5080-3260D12

CP5080-3260D12K

PN 615 162 0050	
GUARD SUPPORT 12" BELTS	2050545513
HANDLE CP5080-3260D12	2050545583
BELT SANDING SET 12" 5PC- CP	2050545573
CONTACT ARM 1/2"x12" - 5/8" diam.	2050545523
CONTACT ARM 1/8"x12"	2050545543
CONTACT ARM 1/2"x12" 5/16" diam	2050545533
BLOWCASE CP5080	2050552173
STICKER BLOWCASE 12" CP5080	2050552183

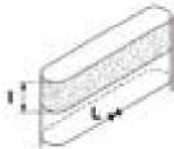

See accessories on pages 98 to 104

CP5080-4200D24



0.5 HP (400 W) BELT SANDER

FEATURES

- 24" (610 mm) belt sander 0.5 hp (400 W)
- Sanding head pivots 360° for multi position sanding
- Easy change of abrasives and contact arm

BENEFITS

- Industrial Maintenance and Production Applications belt sander
- Ergonomic handle and high speed
- High durability thanks to simple and robust design
- Ideal for versatile sanding applications

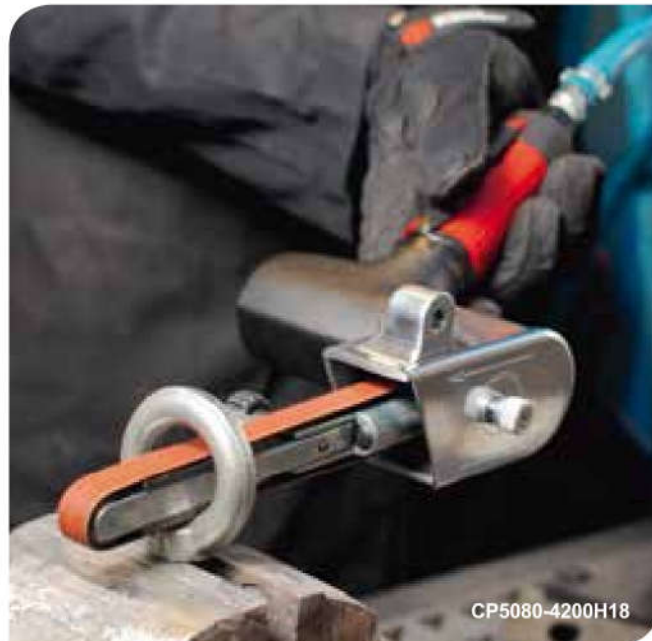

CP5080-4200H18

MODEL	PART NUMBER	FREE SPEED		POWER	BELT CAPACITY L x W		AIR CONS. AT FREE SPEED		AIR CONS. @LOAD		NET WEIGHT		LENGTH		VIBRATION LEVEL ISO 28927 (M/S ²)		SOUND PRESS.	SOUND POWER	AIR INLET
		rpm	hp		W	in.	mm	cfm	l/s	cfm	l/s	lb	kg	in.	mm	a			
CP5080-3260D12	615 162 0000	26,000	0.4	300	12	305	21	10	17.8	8.4	1.7	0.7	11	280	<2,5		81	92.5	1/4"
CP5080-3260D12K	615 162 0050	26,000	0.4	300	12	305	21	10	17.8	8.4	1.7	0.7	11	280	<2,5		81	92.5	1/4"
CP5080-4200D24	615 162 0010	20,000	0.54	400	1/2x24	13x600	25	12	21.6	10.2	3.1	1.3	15	390	<2,5		78	89	1/4"

All models: Hose int. 3/8" (9.5mm) - @90 PSI (@6.3 Bar)

Listed specifications are for reference only. Please check documents in each tool.

<0.75 hp (560W) Belt Sanders

CP5080-4200H18



CP5080-4200H18K

PN 615 162 0040	
GUARD SUPPORT 18" W HANDLE	2050547953
HANDLE CP5080-4200H18	2050545603
HANDLE CP5080-4200H18	2050545563
BELT SANDING SET 18" SPC-CP	2050545483
CONTACT ARM 1/2"x18"	2050545453
CONTACT ARM 5/8" to 3/4"x 18"	2050545473
BLOWCASE CP5080	2050552173
STICKER BLOWCASE 18" CP5080	2050552193



0.5 HP (400 W) BELT SANDER

FEATURES

- 18" (457 mm) belt sander 0.5 hp (400 W)
- Sanding head pivots 360° for multi position sanding
- Easy change of abrasives and contact arm

BENEFITS

- Industrial Maintenance and Production Applications belt sander
- Ergonomic handle and high speed
- High durability thanks to simple and robust design
- Ideal for versatile sanding applications



CP5080-5220H18



See accessories on pages 98 to 104

CP5080-5220H18

0.75 HP (560 W) BELT SANDER

FEATURES

- 18" (457 mm) belt sander 0.75 hp (560 W)
- Sanding head pivots 360° for multi position sanding
- Easy change of abrasives and contact arm

BENEFITS

- Industrial Maintenance and Production Applications belt sander
- Ergonomic handle and high speed
- High durability thanks to simple and robust design
- Ideal for versatile sanding applications



CP5080-5220H18

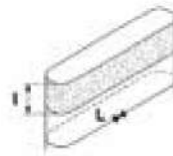

MODEL	PART NUMBER	FREE SPEED		POWER		BELT CAPACITY L x W		AIR CONS. AT FREE SPEED		AIR CONS. @LOAD		NET WEIGHT		LENGTH		VIBRATION LEVEL ISO 28927 (M/S ²)		SOUND PRESS.	SOUND POWER	AIR INLET
		rpm	hp	W	in.	mm	cfm	l/s	cfm	l/s	lb	kg	in.	mm	a	k	ISO 15744 - dB(A)			
CP5080-4200H18	615 162 0020	20,000	0.54	400	1/2x18	13x450	25	12	21.6	10.3	2.8	1.2	13	340	<2,5		80	91	1/4"	
CP5080-4200H18K	615 162 0040	20,000	0.54	400	1/2->3/4x18	13->19x450	25	12	21.6	10.2	3.1	1.3	13	340	<2,5		78	89	1/4"	
CP5080-5220H18	615 162 0030	22,000	0.75	560	18	457	31	15	27.1	12.8	3.3	1.4	13	340	<2,5		84	95	1/4"	

All models: Hose int. 3/8" (9.5mm) - @90 PSI (@6.3 Bar)

Listed specifications are for reference only. Please check documents in each tool.

CP3514

ERGONOMIC & POWERFUL

FEATURES

- 5" (125 mm) random orbital palm sander
- 3/16" (5 mm) orbit
- Powerful 0.3 hp (210 W) motor
- Soft grip, tear drop design for perfect control
- Low noise level
- Shut-off and speed control switch
- Central Vacuum (CV) model in Hook & Loop Pad

BENEFITS

- Operator comfort with ergonomic palm shape
- Productivity increased with low vibrations level
- Powerful and ergonomic palm shape for vertical and horizontal applications
- 3/16" (5 mm): great for surface preparation from body filler to paint primer



CP3514



See accessories on pages 101 to 105

CP3510



ERGONOMIC & POWERFUL

CP3511

Same features as CP3510 with PSA

FEATURES

- 5" (125 mm) random orbital palm sander
- 3/16" (5 mm) orbit
- Powerful 0.3 hp (210 W) motor
- Soft grip, tear drop design for perfect control
- Low noise level
- Shut-off and speed control switch
- Non Vacuum (NV) model in Hook & Loop Pad

BENEFITS

- Operator comfort with ergonomic palm shape
- Productivity increased with low vibrations level
- Powerful and ergonomic palm shape for vertical and horizontal applications
- 3/16" (5 mm): great for surface preparation from body filler to paint primer

CP3512



ERGONOMIC & POWERFUL

FEATURES

- 5" (125 mm) random orbital palm sander
- 3/16" (5 mm) orbit
- Powerful 0.3 hp (210 W) motor
- Soft grip, tear drop design for perfect control
- Low noise level
- Shut-off and speed control switch
- Self Vacuum (SV) model in Hook & Loop pad

BENEFITS

- Operator comfort with ergonomic palm shape
- Productivity increased with low vibrations level
- Powerful and ergonomic palm shape for vertical and horizontal applications
- 3/16" (5 mm): great for surface preparation from body filler to paint primer

MODEL	PART NUMBER	POWER		GRIP	FREE SPEED	PAD CAPACITY		SPINDLE THREAD	AIR CONS. AT FREE SPEED		AIR CONS. @LOAD		NET WEIGHT		PAD TYPE	VAC	VIBRATION LEVEL ISO 28927 (M/S ²)		SOUND PRESS.	SOUND POWER	AIR INLET
		hp	W			in.	mm		in.	cfm	l/s	cfm	l/s	lb			kg	a			
CP3510	615 193 3510	0.3	210	Palm	12,000	5	125	5/16-24	19	9	16.0	8.0	1.3	0.7	H&L	SV	3	1.3	81	92	1/4"
CP3511	615 193 3511	0.3	210	Palm	12,000	5	125	5/16-24	19	9	16.0	8.0	1.3	0.7	PSA	SV	3	1.3	81	92	1/4"
CP3512	615 193 3512	0.3	210	Palm	12,000	5	125	5/16-24	19	9	16.0	8.0	1.3	0.7	H&L	SV	3	1.3	81	92	1/4"
CP3514	615 193 3514	0.3	210	Palm	12,000	5	125	5/16-24	19	9	16.0	8.0	1.4	0.7	H&L	SV	3	1.3	81	92	1/4"

All models: Hose int. 3/8" (9.5mm) - @90 PSI (@6.3 Bar)

Listed specifications are for reference only. Please check documents in each tool.

CP7225



POWERFUL & COMFORTABLE



FEATURES

- 6" (150 mm) random orbital palm sander
- 3/32" (2.5 mm) orbit
- Powerful 0.29 hp (210 W) motor
- Soft grip, tear drop design for perfect control
- Low noise level
- Low vibrations
- Shut-off and speed control switch
- Non Vacuum (NV) model in PSA pad

CP7225E / CV

Similar features as CP7225 with respectively H&L and Central Vacuum

CP7225CVE / SVE

Similar features as CP7225 with H&L, Central Vacuum and with H&L, Self Vacuum

CP7215SV



POWERFUL & COMFORTABLE



FEATURES

- 6" (150 mm) random orbital palm sander
- 3/8" (10 mm) orbit
- Powerful 0.29 hp (210 W) motor
- Soft grip, tear drop design for perfect control
- Low noise level
- Shut-off and speed control switch
- Self Vacuum (SV) model in PSA pad

CP7215/E

Similar features as CP7215SV with H&L

CP7215CV

Similar features as CP7215SV with H&L and Central Vacuum

CP7215CVE/SVE

Similar features as CP7215SV with H&L, Central Vacuum and with H&L, Self Vacuum

CP7255CVE

POWERFUL & COMFORTABLE



FEATURES

- 6" (150 mm) random orbital palm sander
- 3/16" (5 mm) orbit
- Powerful 0.3 hp (210 W) motor
- Soft grip, tear drop design for perfect control
- Low noise level
- Shut-off and speed control switch
- Central Vacuum (CV) model in Hook & Loop Pad

BENEFITS

- Operator comfort with ergonomic palm shape
- Productivity increased with low vibrations level
- Powerful and ergonomic palmshape for vertical and horizontal applications
- 3/16" (5 mm): great for surface preparation from body filler to paint primer



CP7255

Similar features as CP7255CVE with PSA

CP7255E / CV

Similar features as CP7255CVE with respectively H&L and Central Vacuum

CP7255SV / SVE

Similar features as CP7255CVE with respectively Self Vacuum and H&L Self Vacuum

	MODEL	PART NUMBER	POWER		GRIP	FREE SPEED	PAD CAPACITY	SPINDLE THREAD	AIR CONS. AT FREE SPEED		AIR CONS. @LOAD		NET WEIGHT	PAD TYPE	VAC	VIBRATION LEVEL ISO 28927 (M/S ²)		SOUND PRESS.	SOUND POWER	AIR INLET	
			hp	W					cfm	l/s	cfm	l/s				a	k				ISO 15744 - dB(A)
ORBITAL Ø 3/8" (10 mm)	CP7215	894 107 2151	0.3	210	Palm	12,000	6 150	5/16-24	18	8	16.0	7.6	1.7	0.7	PSA	no	8.54	2.8	81	92	1/4"
	CP7215CV	894 107 2153	0.3	210	Palm	12,000	6 150	5/16-24	18	8	16.0	7.6	1.8	0.8	PSA	CV	8.54	2.8	81	92	1/4"
	CP7215CVE	894 127 2153	0.3	210	Palm	12,000	6 150	5/16-24	18	8	16.0	7.6	1.8	0.8	H&L	CV	5.65	1.8	81	92	1/4"
	CP7215E	894 127 2151	0.3	210	Palm	12,000	6 150	5/16-24	18	8	16.0	7.6	1.7	0.7	H&L	no	5.65	1.8	81	92	1/4"
	CP7215SV	894 107 2152	0.3	210	Palm	12,000	6 150	5/16-24	18	8	16.0	7.6	1.8	0.8	PSA	SV	8.54	2.8	81	92	1/4"
ORBITAL Ø 3/32" (2.5 mm)	CP7215SVE	894 127 2152	0.3	210	Palm	12,000	6 150	5/16-24	18	8	16.0	7.6	1.8	0.8	H&L	SV	5.65	1.8	81	92	1/4"
	CP7225	894 107 2251	0.3	210	Palm	12,000	6 150	5/16-24	18	8	16.0	7.6	1.7	0.7	PSA	no	7.65	3.1	81	92	1/4"
	CP7225CV	894 107 2253	0.3	210	Palm	12,000	6 150	5/16-24	18	8	16.0	7.6	1.8	0.8	PSA	CV	7.65	3.1	81	92	1/4"
	CP7225E	894 127 2251	0.3	210	Palm	12,000	6 150	5/16-24	18	8	16.0	7.6	1.7	0.7	H&L	no	3.7	2.0	81	92	1/4"
	CP7225SVE	894 127 2252	0.3	210	Palm	12,000	6 150	5/16-24	18	8	16.0	7.6	1.8	0.8	H&L	SV	3.7	2.0	81	92	1/4"
ORBITAL Ø 3/16" (5 mm)	CP7225CVE	894 127 2253	0.3	210	Palm	12,000	6 150	5/16-24	18	8	16.0	7.6	1.8	0.8	H&L	CV	3.7	2.0	81	92	1/4"
	CP7255SVE	894 127 2552	0.3	210	Palm	12,000	6 150	5/16-24	18	8	16.0	7.6	1.8	0.8	H&L	SV	5.13	1.7	81	92	1/4"
	CP7255SV	894 107 2552	0.3	210	Palm	12,000	6 150	5/16-24	18	8	16.0	7.6	1.8	0.8	PSA	SV	8.22	2.2	81	92	1/4"
	CP7255E	894 127 2551	0.3	210	Palm	12,000	6 150	5/16-24	18	8	16.0	7.6	1.7	0.7	H&L	no	5.13	1.7	81	92	1/4"
	CP7255CVE	894 127 2553	0.3	210	Palm	12,000	6 150	5/16-24	18	8	16.0	7.6	83.0	0.8	H&L	CV	5.13	1.7	81	92	1/4"
	CP7255CV	894 107 2553	0.3	210	Palm	12,000	6 150	5/16-24	18	8	16.0	7.6	83.0	0.8	PSA	CV	8.22	2.2	81	92	1/4"
	CP7255	894 107 2551	0.3	210	Palm	12,000	6 150	5/16-24	18	8	16.0	7.6	1.7	0.7	PSA	no	8.22	2.2	81	92	1/4"

All models: Hose int. 3/8" (9.5mm) - @90 PSI (@6.3 Bar)

Listed specifications are for reference only. Please check documents in each tool.

CP7215H



**LIGHTWEIGHT
& POWERFUL**

CP7215HE / HCVE

Similar features as CP7215H
with handle and H&L / with 2
hands and Central Vacuum



ø 10mm (3/8") Dia. Orbit



Eco change motor,
see page 101

FEATURES

- 2-handed 6" (150 mm) random orbital palm sander
- 3/8" (10 mm) orbit
- Powerful 0.29 hp (210 W) motor
- Soft grip, tear drop design for perfect control
- Low noise level
- Shut-off and speed control switch
- Non Vacuum (NV) model in PSA Pad

BENEFITS

- Operator comfort with ergonomic palm shape
- Productivity increased with low vibrations level
- Powerful and ergonomic palm shape for vertical and horizontal applications
- 3/8" (10 mm): great for heavy material removal such as body filler

CP7255H



**LIGHTWEIGHT
& POWERFUL**

CP7255HE / HCVE

Similar features as CP7255H
with handle and H&L / with 2
hands and Central Vacuum



Eco change motor,
see page 101

FEATURES

- 2-handed 6" (150 mm) random orbital palm sander
- 3/16" (5 mm) orbit
- Powerful 0.3 hp (210 W) motor
- Soft grip, tear drop design for perfect control
- Low noise level
- Shut-off and speed control switch
- Non Vacuum (NV) model in PSA Pad

BENEFITS

- Operator comfort with ergonomic palm shape
- Productivity increased with low vibrations level
- Powerful and easy to use for vertical and horizontal applications
- 3/16" (5 mm): great for surface preparation from body filler to paint primer

CP7268



IN-LINE SANDING

FEATURES

- Heavy-duty dual piston straight line sander
- Twin piston rugged design
- Easy comfort trigger and handle

BENEFITS

- Operator comfort and safe operation
- Ideal tool for fast material removal, body smoothing, and for large surfaces



CP7215HCVE



See accessories on pages 101 to 105

	MODEL	PART NUMBER	FREE SPEED		POWER		PAD CAPACITY		PAPER SIZE		SPINDLE THREAD	AIR CONS. AT FREE SPEED		AIR CONS. @LOAD		NET WEIGHT		VIBRATION LEVEL ISO 28927 (M/S ²)		SOUND PRESS.	SOUND POWER	AIR INLET
			rpm	hp	W	in.	mm	in.	mm	in		cfm	l/s	cfm	l/s	lb	kg	a	k			
ORBITAL ø 3/16" (5 mm)	CP7268	894 107 2680	5,000			2.75 x 17.5	70x445	2.75 x 17.5	70x445		14	6	10.7	5.1	6.0	2.7	22.03	13.5	93	104	1/4"	
	CP7255HE	894 127 2554	11,000	0.3	210	6	150	6	150	5/16-24	18	8	18.0	8.5	1.9	0.8	3.1	5.2	82	93	1/4"	
	CP7255HCVE	894 127 2555	11,000	0.3	210	6	150	6	150	5/16-24	18	8	18.0	8.5	1.9	0.8	3.1	5.2	83	94	1/4"	
ORBITAL ø 3/8" (10 mm)	CP7255H	894 107 2554	11,000	0.3	210	6	150	6	150	5/16-24	18	8	18.0	8.5	1.9	0.8	5.4	2.4	81	92	1/4"	
	CP7215HE	894 127 2154	11,000	0.3	210	6	150	6	150	5/16-24	18	8	18.0	8.5	2.0	0.9	4.4	2.8	85	96	1/4"	
	CP7215HCVE	894 127 2155	11,000	0.3	210	6	150	6	150	5/16-24	18	8	18.0	8.5	2.0	0.9	4.4	2.8	86	97	1/4"	
	CP7215H	894 107 2154	11,000	0.3	210	6	150	6	150	5/16-24	18	8	18.0	8.5	2.0	0.9	4.4	2.8	84	95	1/4"	

All models: Hose int. 3/8" (9.5mm) - @90 PSI (@6.3 Bar)

Listed specifications are for reference only. Please check documents in each tool.

0.3 hp (210W) Orbital Sanders

Finishing

DOBCO EQUIPMENT LTD.

905-672-5557

sales@dobcoeqp.com

www.dobcoeqp.com

CP7220E



HIGH PERFORMANCE WITH LOW NOISE NON VACUUM

CP7220SVE

Similar features as CP7220E with self-vacuum

CP7250E

Similar features as CP7220E with 5 mm orbit

CP7250SVE

Similar features as CP7220SVE with 5 mm orbit and self vacuum

FEATURES

- 0.3 hp (210 W) orbital sander
- True oil-free operation to keep contaminants away from your sanding process
- Non-vacuum model available in PSA and Hook & Loop pads
- Used for final sanding, finishing and prepolishing processes

BENEFITS

- Industrial Maintenance and Production Applications orbital sander
- High durability thanks to simple and robust design
- Ideal for versatile sanding applications

CP7220HCVE



HIGH PERFORMANCE WITH LOW NOISE CENTRAL VACUUM

FEATURES

- 0.3 hp (210 W) orbital sander
- True oil-free operation to keep contaminants away from your sanding process
- Central-vacuum model available in PSA and Hook & Loop pads
- Used for final sanding, finishing and prepolishing processes
- Handle for 2 hand operation

BENEFITS

- Industrial Maintenance and Production Applications orbital sander
- High durability thanks to simple and robust design
- Ideal for versatile sanding applications

CP7220CVE

HIGH PERFORMANCE WITH LOW NOISE CENTRAL VACUUM

FEATURES

- 0.3 hp (210 W) orbital sander
- True oil-free operation to keep contaminants away from your sanding process
- Central-vacuum model available in PSA and Hook & Loop pads
- Used for final sanding, finishing and prepolishing processes

BENEFITS

- Industrial Maintenance and Production Applications orbital sander
- High durability thanks to simple and robust design
- Ideal for versatile sanding applications



CP7220CVE

CP7250CVE

Similar features as CP7220CVE with 5 mm orbit



See accessories on pages 101 to 105

MODEL	PART NUMBER	POWER		GRIP	FREE SPEED	PAD CAPACITY	SPINDLE THREAD	AIR CONS. AT FREE SPEED		AIR CONS. @LOAD		NET WEIGHT		PAD TYPE	VAC	VIBRATION LEVEL ISO 28927 (M/S ²)		SOUND PRESS.	SOUND POWER	AIR INLET
		hp	W					cfm	l/s	cfm	l/s	lb	kg			a	k			
PALM GRIP - ORBITAL Ø 3/32" (2.5mm)																				
CP7220CVE	894 170 2970	0.3	210	Palm	12,000	6 150	5/16-24	16	7	16.6	7.8	1.7	0.7	H&L	CV	3.2	1.4	76	87	1/4"
CP7220E	894 127 2201	0.3	210	Palm	12,000	6 150	5/16-24	16	7	16.6	7.8	1.7	0.7	H&L	no	3.4	1.3	76	87	1/4"
CP7220SVE	894 127 2202	0.3	210	Palm	12,000	6 150	5/16-24	16	7	16.6	7.8	1.7	0.7	H&L	SV	3.2	1.4	76	87	1/4"
PALM GRIP - ORBITAL Ø 3/16" (5mm)																				
CP7250CVE	894 127 2503	0.3	210	Palm	12,000	6 150	5/16-24	16	7	16.6	7.8	1.7	0.7	H&L	CV	5.7	2.9	76	87	1/4"
CP7250E	894 127 2501	0.3	210	Palm	12,000	6 150	5/16-24	16	7	16.6	7.8	1.7	0.7	H&L	no	5	2.3	76	87	1/4"
CP7250HCVE	615 170 3760	0.3	210	2 hand	12,000	6 150	5/16-24	16	7	16.6	7.8	2.0	0.9	H&L	CV	4.4	1.9	81	92	1/4"
CP7250SVE	894 127 2502	0.3	210	Palm	12,000	6 150	5/16-24	16	7	16.6	7.8	1.7	0.7	H&L	SV	5.7	2.9	76	87	1/4"

All models: Hose int. 3/8" (9.5mm) - @90 PSI (@6.3 Bar)

Listed specifications are for reference only. Please check documents in each tool.

www.dobcoeqp.com

sales@dobcoeqp.com

905-672-5557

DOBCO EQUIPMENT LTD.

CP7250HCVE

HIGH PERFORMANCE WITH LOW NOISE CENTRAL VACUUM

FEATURES

- 0.3 hp (210 W) orbital sander
- True oil-free operation to keep contaminants away from your sanding process
- Central-vacuum model available in PSA and Hook & Loop pads
- Used for final sanding, finishing and prepolishing processes
- Handle for 2 hand operation

BENEFITS

- Industrial Maintenance and Production Applications orbital sander
- High durability thanks to simple and robust design
- Ideal for versatile sanding applications



CP7250HCVE



See accessories on pages 101 to 105

CP7220HE



HIGH PERFORMANCE WITH LOW NOISE NON VACUUM

CP7250HE

Similar features as CP7220HE with self-vacuum

FEATURES

- 0.3 hp (210 W) orbital sander
- True oil-free operation to keep contaminants away from your sanding process
- Central-vacuum model available in PSA and Hook & Loop pads
- Used for final sanding, finishing and prepolishing processes
- Handle for 2 hand operation

BENEFITS

- Industrial Maintenance and Production Applications orbital sander
- High durability thanks to simple and robust design
- Ideal for versatile sanding applications

CP9534



HIGH PERFORMANCE WITH LOW NOISE CENTRAL VACUUM

CP9674

Similar features as CP9534 with low noise Central-vacuum

FEATURES

- 0.3 hp (210 W) orbital sander
- True oil-free operation to keep contaminants away from your sanding process
- Central-vacuum model available in PSA and Hook & Loop pads
- Great for surface preparation from body filler to paint primer

BENEFITS

- Industrial Maintenance and Production Applications orbital sander
- High durability thanks to simple and robust design
- Ideal for versatile sanding applications

MODEL	PART NUMBER	POWER		GRIP	FREE SPEED	PAD CAPACITY	SPINDLE THREAD	AIR CONS. AT FREE SPEED		AIR CONS. @LOAD		NET WEIGHT		PAD TYPE	VAC	VIBRATION LEVEL ISO 28927 (M/S ²)		SOUND PRESS.	SOUND POWER	AIR INLET	
		hp	W					cfm	l/s	cfm	l/s	lb	kg			a	k				ISO 15744 - dB(A)
PALM GRIP - ORBITAL Ø 3/32" (2.5mm)																					
CP7220HE	615 170 3770	0.3	210	2 hand	12,000	6 150	5/16-24	16	7	16.6	7.8	2.0	0.9	H&L	SV	5.1	3.2	81	92	1/4"	
PALM GRIP - ORBITAL Ø 3/16" (5mm)																					
CP7250HCVE	615 170 3760	0.3	210	2 hand	12,000	6 150	5/16-24	16	7	16.6	7.8	2.0	0.9	H&L	CV	4.4	1.9	81	92	1/4"	
CP7250HE	615 170 3740	0.3	210	2 hand	12,000	6 150	5/16-24	16	7	16.6	7.8	2.0	0.9	H&L	SV	5.1	2.5	81	92	1/4"	
CP9534	615 193 9534	0.3	210	2 hand	9,000	6 150	5/16-24	9	3	9.0	3.2	2.9	1.3	H&L	CV	2.58	1.1	83	94	1/4"	
PALM GRIP - ORBITAL Ø 3/8" (10mm)																					
CP9674	615 193 9674	0.3	210	2 hand	9,000	6 150	5/16-24	9	3	9.0	3.2	2.3	1.3	H&L	CV	2.54	1.1	83	94	1/4"	

All models: Hose int. 3/8" (9.5mm) - @90 PSI (@6.3 Bar)

Listed specifications are for reference only. Please check documents in each tool.

CP7263E



**ERGONOMIC
& POWERFUL**

CP7263CVE

Similar features as CP7263E with Central Vacuum

FEATURES

- 3"x4-1/4" (74x109 mm) jitterbug rectangle sander
- 3/32" (2.5 mm) orbit
- Powerful 0.3 hp (210 W) motor
- Soft grip, tear drop design for perfect control
- Non-vacuum
- Chemical and impact resistant composite housing
- Hook & Loop pad

BENEFITS

- Operator comfort with ergonomic palm shape
- Powerful and easy to use
- Compact pad great for sanding on small surfaces
- 3/32" (2.5 mm): used for final sanding, finishing, and pre-polishing processes

CP7264E



**ERGONOMIC
& POWERFUL**

CP7264CVE

Similar features as CP7264E with Central Vacuum

FEATURES

- 2-3/4"x7-3/4" (70x198 mm) Jitterbug rectangle sander
- 3/32" (2.5 mm) orbit
- Powerful 0.3 hp (210 W) motor
- Soft grip, tear drop design for perfect control
- Non-vacuum
- Chemical and impact resistant composite housing
- Hook & Loop pad

BENEFITS

- Operator comfort with ergonomic palm shape
- Powerful and easy to use
- Long pad ideal for larger surfaces
- 3/32" (2.5 mm): used for final sanding, finishing, and pre-polishing processes

CP7266E



**ERGONOMIC
& POWERFUL**

CP7266CVE

Similar features as CP7266E with Central Vacuum

FEATURES

- 3-1/4"x5" (80x130 mm) jitterbug rectangle sander
- 3/32" (2.5 mm) orbit
- Powerful 0.3 hp (210 W) motor
- Soft grip, tear drop design for perfect control
- Non-vacuum
- Chemical and impact resistant composite housing
- Hook & Loop pad

BENEFITS

- Operator comfort with ergonomic palm shape
- Powerful and easy to use
- Universal size pad for versatile use
- 3/32" (2.5 mm): used for final sanding, finishing, and pre-polishing processes



See accessories on pages 101 to 105

CP7267E



**ERGONOMIC
& POWERFUL**

CP7267CVE

Similar features as CP7267E with Central Vacuum

FEATURES

- 3-7/8"-5-5/8" (100x144 mm) jitterbug delta sander
- 3/32" (2.5 mm) orbit
- Powerful 0.3 hp (210 W) motor
- Soft grip, tear drop design for perfect control
- Non-vacuum
- Chemical and impact resistant composite housing
- Hook & Loop pad

BENEFITS

- Operator comfort with ergonomic palm shape
- Powerful and easy to use
- Great for corners with the delta pad
- 3/32" (2.5 mm): used for final sanding, finishing, and pre-polishing processes

MODEL	PART NUMBER	FREE SPEED	PAD SIZE		AVERAGE AIR CONS.		AIR CONS. @LOAD		NET WEIGHT		PAD TYPE	AIR INLET	VAC
		rpm	in.	mm	cfm	l/s	cfm	l/s	lb	kg			
ORBITAL Ø 3/32" (2.5mm)													
CP7267E	8941072670	10,000	3-7/8"-5-5/8" delta	100x144 delta	18.0	8.5	1.4	0.6	9.6	3.2	78	89	1/4"
CP7267CVE	8941172670	10,000	3-7/8"-5-5/8" delta	100x144 delta	18.0	8.5	1.5	0.7	9	3.7	78	89	1/4"
CP7266E	894 107 2660	10,000	3-1/4"x5"	80x130	9	4.3	18.0	8.5	1.4	0.6	H&L	1/4"	no
CP7266CVE	894 117 2660	10,000	3-1/4"x5"	80x130	9	4.3	18.0	8.5	1.2	0.7	H&L	1/4"	CV
CP7264E	894 107 2640	10,000	2-3/4"x7-3/4"	70x198	9	4.3	18.0	8.5	1.2	0.7	H&L	1/4"	no
CP7264CVE	894 117 2640	10,000	2-3/4"x7-3/4"	70x198	9	4.3	18.0	8.5	1.6	0.7	H&L	1/4"	CV
CP7263E	894 107 2650	10,000	3"x4-1/4"	74x109	9	4.3	18.0	8.5	1.4	0.6	H&L	1/4"	no
CP7263CVE	894 117 2650	10,000	3"x4-1/4"	74x109	9	4.3	18.0	8.5	1.5	0.6	H&L	1/4"	CV

All models: Hose int. 3/8" (9.5mm) - @90 PSI (@6.3 Bar)

Listed specifications are for reference only. Please check documents in each tool.

Finishing

2.3 hp (1,700W) Sanders

CP3650-085AB

HIGH PERFORMANCE & ERGONOMICS



FEATURES

- 7" (180 mm) pad capacity
- 2.3 hp (1,700 W) high performance governed motor
- 8,500 rpm free speed
- Superior durability bevel gear
- Spindle lock button
- Vibration damping multi-position side handle
- 5/8" 11 Spindle

BENEFITS

- Industrial Maintenance and Production angle sander
- Highest durability in demanding applications up to 2,000 hours maintenance intervals



CP3650-085AB

CP3650-085AAE

Similar features as CP3650-085AB with M14 spindle

CP3650-075AB

Similar features as CP3650-085AB with 7,300 rpm

CP3650-075AAE

Similar features as CP3650-085AB with 7,500 rpm and M14 spindle



See accessories on pages 102 to 105

CP3650-120AB



HIGH PERFORMANCE & ERGONOMICS



CP3650-120AAE

Similar features as CP3650-120AB with M14 spindle

CP3650-135AC4SE

Similar features as CP3650-120AB with 3/8-24 spindle with 13,500 rpm and with 3/8-24 spindle

FEATURES

- 5" (125 mm) pad capacity
- 2.3 hp (1,700 W) high performance governed motor
- 12,000 rpm free speed
- Superior durability bevel gear
- Spindle lock button
- Vibration damping multi-position side handle
- 5/8" Spindle

BENEFITS

- Industrial Maintenance and Production angle sander
- Highest durability in demanding applications up to 2,000 hours maintenance intervals

See all CP3650 Unique Features on page 68



CP3650-120AB

MODEL	PART NUMBER	FREE SPEED		POWER		PAD CAPACITY		SPINDLE TRHEAD	AIR CONS. AT FREE SPEED		AIR CONS. @LOAD		NET WEIGHT		LENGTH		VIBRATION LEVEL ISO 28927 (M/S ²)		SOUND PRESS. ISO 15744 - dB(A)	SOUND POWER	AIR INLET
		rpm	hp	W	in.	mm	in.		cfm	l/s	cfm	l/s	lb	kg	in.	mm	a	k			
CP3650-075AB	615 160 7280	7,500	2.3	1,700	7	180	5/8-11	32	15	57.0	27.0	3.1	1.4	9	238	3.3	1.6	78	89	3/8"	
CP3650-085AB	615 162 0190	8,500	2.3	1,700	7	180	5/8-11	42	20	68.0	32.0	3.0	1.3	9	238	3.4	1.7	80	91	3/8"	
CP3650-120AB	615 160 7250	12,000	2.3	1,700	5	125	5/8-11	42	20	68.0	32.0	3.1	1.4	9	238	2.9	1.5	86	97	3/8"	
CP3650-075AAE	615 160 7270	7,500	2.3	1,700	7	180	M14	32	15	57.0	27.0	3.0	1.3	9	238	3.3	1.6	79	90	3/8"	
CP3650-085AAE	615 160 7260	8,500	2.3	1,700	7	180	M14	42	20	68.0	32.0	3.0	1.3	9	238	3.4	1.7	80	91	3/8"	
CP3650-120AAE	615 160 7240	12,000	2.3	1,700	5	125	M14	42	20	68.0	32.0	3.0	1.3	9	238	2.9	1.5	85	96	3/8"	
CP3650-135AC4SE	615 160 7290	13,500	2.3	1,700	4	115	3/8-24	53	25	74.0	35.0	3.3	1.4	9	238	4.8	3.6	85	96	3/8"	

All models: Hose int. 3/8" (9.5mm) - @90 PSI (@6.3 Bar)

Listed specifications are for reference only. Please check documents in each tool.

CP3850-65ABVE



UNIQUE FEATURES
Premium Tool



CP3850-60AB SUPERLATIVE PERFORMANCE & ERGONOMICS

Similar features as CP3850-65ABVE with 6,000 rpm free speed and without autobalancer

For ANSI markets

FEATURES

- 9" (230 mm) pad capacity
- 2.8 hp (2,100 W) high performance governed motor
- 6,500 rpm free speed
- Low profile angle head
- Superior durability bevel gear
- Curved handle housing
- Double action safety lever
- Integrated silencer
- Orientable exhaust
- Spindle lock button
- Auto balancer
- Vibration damping multi-position side handle
- CE certification / not for North American Market

BENEFITS

- Industrial Maintenance and Production angle sander
- Highest durability in demanding applications up to 2,000 hours maintenance intervals
- Superior torque for maximal productivity
- Superior ergonomics

See all CP3850 Unique Features on page 72



CP3850-65ABVE

CP3850-85ABVE

SUPERLATIVE PERFORMANCE & ERGONOMICS

UNIQUE FEATURES
Premium Tool

FEATURES

- 7" (180 mm) pad capacity
- 2.8 hp (2,100 W) high performance governed motor
- 8,500 rpm free speed
- Low profile angle head
- Superior durability bevel gear
- Curved handle housing
- Double action safety lever
- Integrated silencer
- Orientable exhaust
- Spindle lock button
- Auto balancer
- Vibration damping multi-position side handle
- CE certification / not for North American Market

BENEFITS

- Industrial Maintenance and Production angle sander
- Highest durability in demanding applications up to 2,000 hours maintenance intervals
- Superior torque for maximal productivity
- Superior ergonomics



CP3850-85ABVE

CP3850-77AB

Similar features as CP3850-85ABVE with 7,700 rpm free speed and without autobalancer for ANSI markets



See accessories on pages 102 to 105

MODEL	PART NUMBER	FREE SPEED		POWER		PAD CAPACITY		SPINDLE TRHEAD		AIR CONS. AT FREE SPEED		AIR CONS. @LOAD		NET WEIGHT		LENGTH		VIBRATION LEVEL ISO 28927 (M/S ²)		SOUND PRESS. ISO 15744 - dB(A)	SOUND POWER	AIR INLET
		rpm	hp	W	in.	mm	in.	cfm	l/s	cfm	l/s	lb	kg	in.	mm	a	k					
ANSI MODELS																						
CP3850-60AB	615 170 5000	6,000	2.8	2,100	9	230	5/8-11	38	18	80.0	38.0	5.1	2.3	13	340	<2.5		86	97	1/2"		
CP3850-77AB	615 170 4990	7,700	2.8	2,100	7	180	5/8-11	33	16	69.0	32.0	4.1	2.3	13	340	3.6	0.8	84	95	1/2"		
CE MODELS - NOT FOR NA																						
CP3850-65ABVE	615 170 4980	6,500	2.8	2,100	9	230	5/8-11	44	21	80.0	38.0	5.1	2.3	13	340	<2.5		89	100	1/2"		
CP3850-85ABVE	615 170 4970	8,500	2.8	2,100	7	180	5/8-11	36	17	77.0	36.0	5.1	2.3	13	340	<2.5		87	98	1/2"		

All models: Hose int. 5/8" (15mm) - @90 PSI (@6.3 Bar)

Listed specifications are for reference only. Please check documents in each tool.

Finishing



Accessories & Spares

ANGLE SANDERS 2&3" PISTOL SANDERS



BACK-UP PLATE

MODEL	DESCRIPTION	PART NO.
CP9778	ø 4.75" (120mm) Back-up	KF137214
CP9778	ø 3.75" (95mm) Back-up	KF137215
CP9778	ø 3" (75mm) Back-up	KF137216
CP7202D	3" ROL-LOC/twist lock backing pad, 1/4 - 20 female thread (must be used with Surface Prep Pad)	CA158102

ACCESSORIES INCLUDED

MODEL	DESCRIPTION	PART NO.
CP3019-..	Exhaust hose 31" (0.80m)	615 875 1060
	Flat wrench	615 801 0030

MODEL	ITEM	DESCRIPTION	PART NO.
CP3070	1	Backing pad 5" (125mm)	205 054 8393
	2	Backing pad 3" (76mm)	205 054 8383
	3	Holder flange	205 054 8403
	.	Wrench kit	205 054 8333

OPTIONAL ACCESSORIES

PADS

MODEL	CAPACITY	PART NO.
CP3019-..	2" (50mm) Pad	205 054 9913
	3" (76mm) Pad	205 054 9923
CP3030-325AFR	2" (50mm) Pad	205 054 9913
CP3030-4/5..AFR	3" (76mm) Pad	205 054 9933

SILENCERS

MODEL	DESCRIPTION	PART NO.
CP3019-..	Silencer kit	615 396 1010
	Clippable silencer	615 396 1240
CP3030-..	Clippable silencer	615 396 1240

COLLET HOLDER

MODEL	ITEM	CAPACITY	PART NO.
CP3030-4..AFR	1	Series 200 collet holder	615 523 0230
CP3030-5..AFR	2	Series 200 collet nut	615 607 1440
	3	Collet, ø 1/8" (2.4 to 3.2mm)	615 526 0610
	.	Collet, ø 5.2 to 6mm	615 526 0620
	.	Collet, ø 1/4" (5.55 to 6.35mm)	615 526 0630
	.	Collet, ø 7.2 to 8mm	615 526 0640

GREASE GUN

MODEL	DESCRIPTION	PART NO.
CP3019-..	Grease gun (capacity 0.8 oz - 24g)	615 990 1490

TUNE-UP KITS

MODEL	PART NO.
CP3070-120G	205 054 8293
CP3030-3..	205 054 6403
CP3030-4..	205 054 7863
CP3030-5..	205 054 7923
CP9778	205 050 6663
CP9779	205 050 3853
CP9780	205 050 3863



Accessories & Spares

BELT SANDERS





OPTIONAL ACCESSORIES

CP5080-3260 Series - 12" (305mm)

	GUARD SUPPORT	PART NO.		PART NO.		PART NO.		
	12" (305mm) Guard support	205 054 5513						
	1/2"x12" (13x305mm) - 5/8" (16mm)	205 054 5523		1/2" (13mm) - 5/8" (16mm)	205 054 6443		1/2" x 1.97" (12.5 x 50mm)	205 054 6243
	1/2"x12" (13x305mm) - 5/16" (8mm)	205 054 5533		1/2" (13mm) - 5/16" (8mm)	205 055 0283		1/2" x 1-15/16" (12.5 x 49mm)	205 054 6233
	1/8"x12" (3x305mm)	205 054 5543		1/8" (3mm)	205 054 6473			
	1/4"x12" (6x305mm)	205 054 5553		1/4" (6mm)	205 054 6493		5/16" x 2.05" (7.5 x 52mm)	205 054 6253

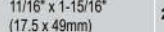
CP5080-4200 Series - 18" (457mm)

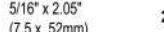
	GUARD SUPPORT	PART NO.		PART NO.		PART NO.		
	18" (457mm) Guard support	205 054 5443						
	18" (457mm) Guard support with side handle	205 054 7953						
	5/8" to 3/4" x 18" (16 to 19 x 457mm)	205 054 5453		5/8" (16mm)	205 054 6433		3/4" x 2-1/8" (19.5 x 54mm)	205 054 6263
	1/2" x 18" (13 x 457mm)	205 054 5463		1/2" (13mm)	205 055 0273		11/16" x 1-15/16" (17.5 x 49mm)	205 054 6273
	1/8" to 1/2" x 18" (3 to 13 x 457mm)	205 054 5473		1/8" (3mm)	205 054 6473			
	1/2" x 18" (13 x 457mm)	205 054 5483		1/2" (13mm)	205 054 6483		1/2" x 2-1/8" (12.5 x 54mm)	205 054 6283
	1/4" x 18" (6 x 457mm)	205 054 5493		1/4" (6mm)	205 054 6493		5/16" x 2.05" (7.5 x 52mm)	205 054 6253
	1" x 18" (25 x 457mm)	205 054 5503		1" (25mm)	205 054 6423		26 x 55	205 054 6293

CP5080-5220 Series - 24" (610mm)

	GUARD SUPPORT	PART NO.		PART NO.		PART NO.		
	24" (610mm) Guard support	205 054 5413						
	1/2"x24" (13x610mm)	205 054 5423		1/2" (13mm)	205 054 6443		1/2" x 1.97" (12.5 x 50mm)	205 054 6243
	1/4" to 1/2"x24" (6 to 12x610mm)	205 054 5433		1/4" (6mm)	205 054 6473			



TUNE-UP KITS

MODEL	PART NO.
CP5080-3260..	205 054 6403
CP5080-4200..	205 054 7863
CP5080-5220..	205 054 7923

Finishing



Accessories & Spares BELT SANDERS



BELT SANDERS

DESCRIPTION	IMPERIAL (" INCHES)	METRIC (MM)	FOR TOOL 1/2	FOR TOOL 2/2	GRIT	UNITS	PART NUMBER
Sanding belt	1/8 x 12	3 x 300	CP5080-3260D12(K) + 2050545543 contact arm	-	120	10	894 016 9706
					80	10	894 016 9705
					120	10	894 016 9710
	1/4 x 12	6 x 300	CP5080-3260D12(K) + 2050545553 contact arm	-	40	10	894 016 9707
					60	10	894 016 9708
					80	10	894 016 9709
	1/2 x 12	13 x 300	CP5080-3260D12(K) + 2050545533 contact arm	-	120	10	894 016 9714
					40	10	894 016 9711
					60	10	894 016 9712
	3/8 x 13	10 x 330	CP9779, CP858	-	80	10	894 016 9713
					100	10	894 016 9005
					120	10	894 016 9006
	1/8 x 18	3 x 450	CP5080-4200H18 + 2050545474 contact arm	CP5080-5220H18 + 2050545474 contact arm	60	10	894 016 9003
					80	10	894 016 9004
					120	10	894 016 9716
	1/4 x 18	6 x 450	CP5080-4200H18 + 2050545493 contact arm	CP5080-5220H18 + 2050545493 contact arm	40	10	894 016 9717
					60	10	894 016 9718
					80	10	894 016 9719
	1/2 x 18	13 x 450	CP5080-4200H18	CP5080-5220H18 + 2050545463 contact arm	120	10	894 016 9724
					40	10	894 016 9721
					60	10	894 016 9722
	3/4 x 18	20 x 450	CP5080-4200H18 + 2050545453 contact arm	CP5080-5220H18 + 2050545453 contact arm	80	10	894 016 9723
					120	10	894 016 9728
					40	10	894 016 9725
	1 x 18	25 x 450	CP5080-4200H18 + 2050545503 contact arm	CP5080-5220H18	60	10	894 016 9732
					80	10	894 016 9729
					100	10	894 016 9730
	3/4 x 20,4	20 x 520	CP9780	-	120	10	894 016 9009
					60	10	894 016 9007
					80	10	894 016 9008
	1/4 x 24	6 x 600	CP5080-4220D24 + 2050545433 contact arm	-	120	10	894 016 9736
					40	10	894 016 9733
					60	10	894 016 9734
	1/2 x 24	13 x 600	CP5080-4220D24	-	80	10	894 016 9735
					120	10	894 016 9740
					40	10	894 016 9737
					60	10	894 016 9738
					80	10	894 016 9739

BELT SANDING SET 12" 5PC - CP

Sanding belt	1/2 x 12	13 x 300	CP5080-3260D12(K) + 2050545533 contact arm	-	80	1	
					120	1	
					4913 Medium	1	205 054 5573
	1/4 x 12	6 x 300			80	1	
					120	1	

BELT SANDING SET 18" 8PC - CP

Sanding belt	3/4 x 18	20 x 450	CP5080-4200H18 + 2050545453 contact arm	CP5080-5220H18 + 2050545453 contact arm	80	1	
					120	1	
					4913 Medium	1	
Sanding belt	1/2 x 18	13 x 450	CP5080-4200H18	CP5080-5220H18 + 2050545463 contact arm	80	1	205 054 5563
					120	1	
					4913 Medium	1	
Sanding belt	1/4 x 18	6 x 450	CP5080-4200H18 + 2050545493 contact arm	CP5080-5220H18 + 2050545493 contact arm	80	1	
					120	1	

TUNE-UP KIT & REPAIR KIT



MODEL	TUNE-UP KIT	MAINTENANCE KIT
CP7220/50..	894 015 8345	894 015 8346
CP7225/55-3 Series	894 016 3459	205 052 2433
CP7215/55H Series	894 016 5875	205 052 2433
CP7215/25/55 Series	894 016 3459	205 052 2433
CP7263/64/66/67 Series	894 016 3459	

MODEL	TUNE-UP KIT
CP7265S/CP7265P	894 016 7963
CP7269S/CP7269P	894 016 7963
CP9778	205 050 6663
CP9779	205 050 3853
CP9780	205 050 3863



Accessories
ORBITAL SANDERS

ACCESSORIES INCLUDED

MODEL	DESCRIPTION	PART NO.
CP7220/50E	6" (150mm) Pad H&L	615 990 1540
CP7220/50HE	6" (150mm) Pad PSA	615 990 1590
CP7220/50CVE/HCVE	6" (150mm) Pad H&L with 6 holes	615 990 1550
CP7220/50SVE	6" (150mm) Pad PSA with 6 holes	615 990 1600
CP9534/CP9674	6" (150mm) Pad H&L with 6 holes	352493
CP7220/50SVE	Dust extraction kit	894 015 8430

OPTIONAL ACCESSORIES

ECO CHANGE MOTOR

MODEL	PART NO.
CP7225-3 Series	894 016 8370
CP7255-3 Series	894 016 8371
CP7225 Series	894 016 8372
CP7255 / CP35.. Series	894 016 8373
CP7215 Series	894 016 8374

VACUUM HOSE ADAPTERS FOR CENTRAL VACUUM SANDERS

MODEL	DESCRIPTION	PART NUMBER
CP7220/50(H)CVE CP7225/55CVE-3, CP3514/15, CP7225/55/15CV(E), CP7255/15HCVE CP7263/64/66/67CVE	Vacuum hose adaptor ø 1" (25 mm) / ø 1-1/4" (32 mm)	615 350 1170
CP7220/50(H)CVE CP7225/55CVE-3, CP3514/15, CP7225/55/15CV(E), CP7255/15HCVE CP7263/64/66/67CVE	Vacuum hose adaptor ø 1" (25 mm) / ø 1-1/8" (28 mm)	615 804 4480

DUST EXTRACTION KIT FOR SELF GENERATE VACUUM

MODEL	DESCRIPTION	PART NUMBER
CP3512/13, CP7225/55/15SV(E)	Dust extraction kit (incl. 1 dust bag and its dust hose)	205 052 2453
CP3512/13, CP7225/55/15SV(E)	Dust bag set (incl. 5 dust bags)	205 052 3203
CP3512/13, CP7225/55/15SV(E)	Dust bag set (incl. 1 dust bag)	205 052 3063

DUST EXTRACTION KIT

MODEL	DESCRIPTION	PART NO.
CP7220/7250 CP9534/9674	Dust extraction kit	894 015 8430

OPTIONAL ACCESSORIES

SANDING PADS (THREAD 5/16"-24)

MODEL	DESCRIPTION	PART NO.
CP7220/50E	6" (150mm) Pad H&L	205 052 3033
CP7220/50HE	6" (150mm) Pad PSA	894 016 3455
CP7220/50CVE/HCVE	6" (150mm) Pad PSA with 6 holes	205 052 3043
CP7220/50CVE/HCVE	6" (150mm) Pad PSA with 15 holes	894 016 8235
CP7220/50CVE/HCVE	6" (150mm) Pad H&L with 15 holes	894 016 8236
CP9534/9674	6" (150mm) Pad H&L	CA149405
CP9534/9674	6" (150mm) Pad PSA with 6 holes	615 990 1180
CP9534/9674	6" (150mm) Pad H&L with 6 holes	615 990 1260
CP9534/9674	Key for pad	164433

SANDING PADS

MODEL	DESCRIPTION	PART NUMBER
CP7225/55/15(H)	ø 6" (150 mm) Pad PSA with 15 holes	894 016 8235
CP7225/55/15(H)	ø 6" (150 mm) Pad H&L with 15 holes	894 016 8236
CP7225/55/15(H)	ø 6" (150 mm) Pad PSA with 7 holes	894 016 3457
CP7225/55/15(H)	ø 6" (150 mm) Pad H&L with 7 holes	894 016 3458
CP7225/55/15(H)	ø 6" (150 mm) Pad PSA with 6 holes	894 015 8621
CP7225/55/15(H)	ø 6" (150 mm) Pad H&L with 6 holes	894 015 8690
CP7225/55/15(H)	ø 6" (150 mm) Pad PSA	894 016 3455
CP7225/55/15(H)	ø 6" (150 mm) Pad H&L	894 016 3456
CP3513/15	ø 5" (125 mm) Pad PSA with 5 holes	894 016 6667
CP3512/14	ø 5" (125 mm) Pad H&L with 5 holes	894 016 6668
CP3511	ø 5" (125 mm) Pad PSA	894 016 6665
CP3510	ø 5" (125 mm) Pad H&L	894 016 6666
CP7225/55-3	ø 3" (75 mm) Pad PSA w/o hole	894 016 7203
CP7263E	3"x4-1/4" (74X109 mm) - NV - H&L Pad	894 016 8997
CP7263CVE	3"x4-1/4" (74X109 mm) - CV - H&L Pad	894 016 8998
CP7264 Serie	2-3/4"x7-3/4" (70X198 mm) - CV - H&L Pad Set	894 016 9002
CP7266E	3-1/4"x5" (80X130 mm) - NV - H&L Pad	894 016 8999
CP7266CVE	3-1/4"x5" (80X130 mm) - CV - H&L Pad	894 016 9000
CP7267 Serie	3-7/8"-5-5/8" delta (100x144 mm) - CV - H&L Pad Set	894 016 9001

SANDING PAPER

ROL-LOC SURFACE PREPARATION PAD
(must be used with the 3" ROL-LOC back-up pad)

MODEL	DESCRIPTION	PART NUMBER
CP7202D	ø 3" (75 mm) Sanding disc 60 Grit (5 pc)	894 016 1712
CP7202D	ø 3" (75 mm) Sanding disc 80 Grit (5 pc)	894 016 1713
CP7202D	ø 3" (75 mm) Sanding disc 100 Grit (5 pc)	894 016 1714
CP7202D	ø 3" (75 mm) Sanding disc 120 Grit (5 pc)	894 016 1715
CP7202D	ø 3" (75 mm) Surface Prep Pad (fine) (5 pc)	894 016 1716
CP7202D	ø 3" (75 mm) Surface Prep Pad (medium) (5 pc)	894 016 1717
CP7202D	ø 3" (75 mm) Surface Prep Pad (course) (5 pc)	894 016 1718
CP7265/69	Nut retainer	KF129586

SANDING ACCESSORIES

MODEL	DESCRIPTION	PART NUMBER
CP9778	Flange	205 048 5053
	Rod-key	205 048 5043

BACK-UP PLATE

MODEL	DESCRIPTION	PART NUMBER
CP9778	ø 4.75" (120 mm) Back-up	KF137214
	ø 3.75" (95 mm) Back-up	KF137215
	ø 3" (75 mm) Back-up	KF137216
CP7202D	3" ROL-LOC Backing pad, 1/4 - 20 female thread (must be used with Surface Prep Pad)	CA158102

Finishing



Accessories

CP3650 ACCESSORIES INCLUDED

MODEL	ITEM	DESCRIPTION	PART NUMBER
CP3650	1	3/8" air hose nipple for 1/2" (13mm) ID hose	615 704 0270
	2	Hose Clamp	615 263 0240
	3	Exhaust hose	615 875 1130
	4	Spanner wrench 17 mm	615 995 1070
	5	Side handle	615 576 0380



MODEL	ITEM	DESCRIPTION	PART NUMBER
CP3650-135AC4SE	1	Vibration-damping side handle	615 576 0660
	2	Flange	615 606 5150
	3	Backing with nut	615 990 1670
	4	Pin wrench	615 802 0080

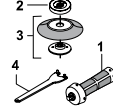

CP3650 OPTIONAL ACCESSORIES

DUST EXTRACTION KIT Ø5" (125 MM) FOR COMPOSITE (NON METAL SANDING)

MODEL	ITEM	DESCRIPTION	PART NUMBER
CP3650	1	Complete kit	615 397 8280
	1	Suction cap	615 504 1940
	2	Spacer 15 mm (5/8")	615 643 0880
	2	Spacer 15 mm (M14)	615 643 0870
	3	Skirt with brush 5"	615 570 2340
	4	Nut (5/8")	615 606 0450
4	Nut (M14)	615 606 0460	
5	Backing pad 5" (rigid) (82)	615 990 1990	
6	Pin wrench 1-3/8"	615 802 0100	

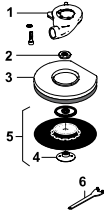

DUST EXTRACTION KIT Ø5" (125 MM) FOR COMPOSITE CUTTING (DIAMOND DISC)

MODEL	ITEM	DESCRIPTION	PART NUMBER
CP3650	1	Complete kit	615 397 8300
	1	Manifold cutting with screws	615 504 2170
	2	Goble cover plate complete	615 504 2180
	2	Spacer 6mm - Hole 14mm	615 643 0920
	3	Spacer 6mm - Hole 16mm	615 643 0910
	4	Spacer for M14 spindle	615 643 0890
	4	Spacer for 5/8" spindle	615 643 0900
	5	Flange nut M14	615 606 0460
	5	Flange nut 5/8"	615 606 0450
	-	Pin key	615 802 0670



MODEL	ITEM	DESCRIPTION	PART NUMBER
CP3650	1	Silencer kit (55) (-11 dB)	615 396 1660
	2	Vibration-damping side handle	615 576 0660
	3	Reinforced cloth-lined exhaust hose L=30"	615 875 1160
	4	Hose clamp	615 263 0240
	5	Clippable silencer (-6 dB)	615 396 9570
	6	Grease gun include 24g	615 990 1490
	7	Grease for bevel gear (1kg)	615 990 1480
	8	Blades kit (x100)	615 340 0640
-	Diamond disc 5" (125 mm)	615 804 9150	

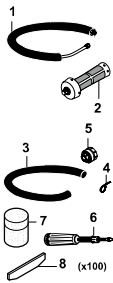

DUST EXTRACTION KIT Ø7" (180 MM) FOR COMPOSITE (NON METAL SANDING)

MODEL	ITEM	DESCRIPTION	PART NUMBER
CP3650	1	Complete kit	615 397 8290
	1	Suction cap	615 504 1940
	2	Spacer 15 mm (5/8")	615 643 0880
	2	Spacer 15 mm (M14)	615 643 0870
	3	Skirt with brush	615 570 2310
	4	Nut (5/8")	615 606 0450
4	Nut (M14)	615 606 0460	
5	Backing pad 7" (rigid) (82)	615 990 1980	
6	Pin wrench 1-3/8" (35 mm)	615 802 0100	

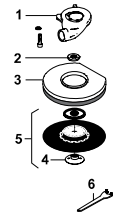

MODEL	ITEM	DESCRIPTION	PART NUMBER
CP3650	1	Sanding guard 7" (180 mm) kit	615 504 2050



MODEL	ITEM	DESCRIPTION	PART NUMBER
CP3650	1	Semi-hard backing pad Ø5" (125mm) with nut M14 & 5/8" (max speed 12000 rpm)	615 804 0740

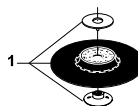

SANDING KIT FOR STANDARD ABRASIVE DISC Ø5" (125MM)

MODEL	ITEM	DESCRIPTION	PART NUMBER
CP3650 (A&B)	1	Complete kit	615 396 0720
	1	Guard	615 504 1450
	2	Ventilated backing	615 990 1270
	3	M14 washer	615 641 0270
	3	5/8" washer	615 642 0500
	4	Nut (M14)	615 606 0220
4	Nut (5/8)	615 606 0290	
5	Hex key 5/16"	615 802 0610	
6	Pin wrench 1-3/8" (35 mm)	615 802 0100	

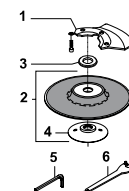



Accessories

CP3650 OPTIONAL ACCESSORIES

MODEL	ITEM	DESCRIPTION	PART NUMBER
CP3650-075AAE	1	Backing pad 7" (180 mm)(soft)	615 990 1330
CP3650-085AAE	1	Backing pad 7" (180 mm) (rigid)	615 990 1340
	2	Nut (M14)	615 606 0220
	2	Nut (5/8")	615 606 0290
	-	Pin wrench 1-3/8" (35 mm)	615 802 0100

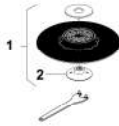

MODEL	ITEM	DESCRIPTION	PART NUMBER
CP3650-075AAE	1	Rigid velcro-backed backing pad 7" (180 mm) (M14x2)	615 990 1450
CP3650-085AAE	1	Rigid velcro-backed backing pad 6" (150 mm) (M14x2)	615 990 1370



MODEL	ITEM	DESCRIPTION	PART NUMBER
CP3650-075AB	1	Rigid velcro-backed backing pad 7" (180 mm) (5/8"-11)	615 990 1460
CP3650-085AB	1	Rigid velcro-backed backing pad 6" (150 mm) (5/8"-11)	615 990 1380



SANDING KIT FOR SEMI-RIGID DISC Ø5" (125 MM)

MODEL	ITEM	DESCRIPTION	PART NUMBER
CP3650-..AA		Complete kit	615 396 0750
	1	Guard (CE only)	615 504 1450
	2	M14 washer	615 641 0270
	3	Nut (M14)	615 606 0220
	4	Complete backing	615 990 1290
	5	Hex key 5/16"	615 802 0610
	-	Pin wrench 1-3/8" (35 mm)	615 802 0100

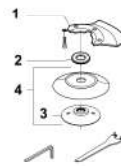

SANDING WITH SPIRACOO PAD (MAX 8500 rpm) Ø7" (180 MM)

MODEL	ITEM	DESCRIPTION	PART NUMBER
CP3650-075AB	1	Spiracool pad	S091836
	2	Hex key 5/16"	615 802 0610

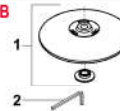

TUNE-UP KIT & REPAIR KIT



MODEL	PART NUMBER
CP3650	205 055 6003

CP3850 ACCESSORIES INCLUDED

MODEL	DESCRIPTION	PART NUMBER
CP3850-60AB/77AB	Vibration damping side handle	615 576 0660
	1/2" Air hose nipple for 5/8" (15 mm) ID hose	615 704 0140
	Rear flange	615 503 1070

MODEL	DESCRIPTION	PART NUMBER
CP3850-65ABVE	Vibration damping side handle	615 576 0660
CP3850-85ABVE	1/2" Air hose nipple for 5/8" (15 mm) ID hose	615 704 0140
	Auto balancer	615 990 1950

CP3850 OPTIONAL ACCESSORIES

MODEL	ITEM	DESCRIPTION	PART NUMBER
	1	Rigid backing pad with nut 5/8", Ø 180 mm (7") - (max. 8,500 rpm)	615 990 1340
	2	Grease gun	615 990 1490
	3	Grease for bevel gear (1Kg)	615 990 1480



MODEL	ITEM	DESCRIPTION	PART NUMBER
CP3850-65ABVE / CP3850-60AB	1	Rear flange (ABVE)	615 503 1070
	2	Pin spanner 1-3/8" (35 mm)	615 802 0100
	3	Soft backing Pad 9" (230 mm) kit	615 990 1410

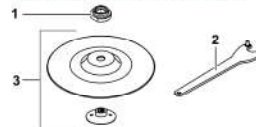

TUNE-UP KIT & REPAIR KIT



MODEL	DESCRIPTION	TUNE-UP KIT
CP3850	Motor Service Kit	205 055 3543
	Spindle Service Kit	205 055 3553
	Global Service Kit	205 055 3433

Finishing



Accessories

CP3850 OPTIONAL ACCESSORIES

DUST EXTRACTION KIT Ø7" (180 MM) FOR COMPOSITE (NON METAL SANDING)

MODEL	ITEM	DESCRIPTION	PART NUMBER
CP3850-85ABVE / CP3850-65ABVE CP3850-77AB / CP3850-60AB	1	Complete kit Manifold CP3850 with screws Push fit hood with brush Spacer 9mm Spacer 6mm hole 16mm Backing pad 180mm Flange nut 5/8 H16 Pin key	205 055 3563 615 504 2190 615 570 2310 615 643 0930 615 643 0910 615 990 2000 615 606 0470 615 802 0670

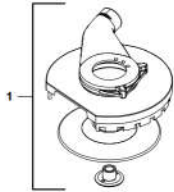

DUST EXTRACTION KIT Ø7" (180 MM) FOR COMPOSITE CUTTING (DIAMOND DISC)

MODEL	ITEM	DESCRIPTION	PART NUMBER
CP3850-85ABVE / CP3850-65ABVE / CP3850-77AB / CP3850-60AB	1	Complete kit Manifold CP3850 cutting with Gable cover plate complete Spacer 25mm hole 16mm Flange nut 5/8 H21 Pin key Diamond cutter blade 180mm	205 055 3573 615 504 2200 615 504 2210 615 643 0900 615 606 0480 615 802 0100 615 811 1450

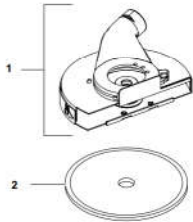

MODEL	ITEM	DESCRIPTION	PART NUMBER
CP3850-85ABVE / CP3850-77AB	1	Rear flange (ABVE)	615 503 1070
	2	Pad 7" (180mm) kit	615 990 1330
	3	Pin spanner 1-3/8" (35 mm)	615 802 0100

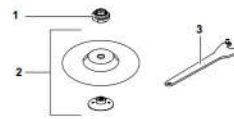

MODEL	ITEM	DESCRIPTION	PART NUMBER
CP3850-85ABVE / CP3850-77AB	1	Rear flange (ABVE)	615 503 1070
	2	Rigid Pad 7" (180mm)	615 990 1340
	3	Pin spanner 1-3/8" (35 mm)	615 802 0100

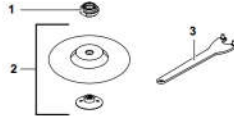

MODEL	ITEM	DESCRIPTION	PART NUMBER
CP3850-77AB	1	Spiracool Pad 7" (180mm)	S091836
	2	Pin spanner 1-3/8" (35 mm)	615 802 0100



DIMENSIONS

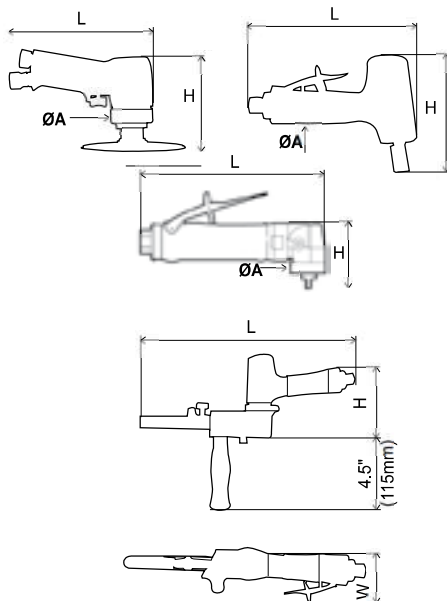

	L		H		A	
	in.	mm	in.	mm	in.	mm
CP7202	6.5	166	4.3	110		
CP3030-3...	6.1	154	4.1	103	1.6	41
CP3030-4...	6.8	174	3.7	93	1.7	43
CP3030-5...	6.8	174	5.5	139	1.7	43
CP3019-...AF	6.5	166	3.7	93	1.18	30
CP3070-120G	6.9	175	4.2	108	1.97	50
CP9778	8.2	203	4.5	115		

BELT SANDERS	L		H		A	
	in.	mm	in.	mm	in.	mm
CP858	11.8	300	3.35	85	1.78	45
CP9778	11.8	300	3.35	85	1.78	45
CP9780	14.4	365	4?14	105	2.75	70
CP5080-3260D12	11.4	290	3.7	95	2.7	70
CP5080-4200D24	15.3	390	4.5	115	2.9	75
CP5080-3260H18	13.4	340	9.8	250	3.1	80
CP5080-5220H18	13.4	340	9.8	250	3.1	80

DIMENSIONS

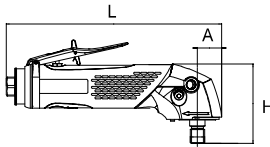
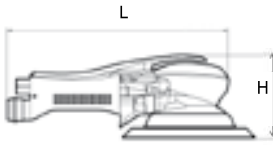
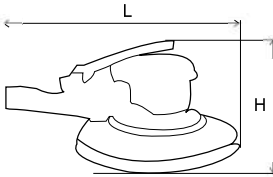

ORBITAL SANDERS	L		H	
	in	mm	in	mm
CP3510	6.29	160	4.13	105
CP3511	6.29	160	4.13	105
CP3512	8.3	211	4.13	105
CP3514	7.87	200	4.13	105
CP7215/25/55 - (NV)-E	7.28	185	4.13	105
CP7215CV/25CV/55CV -E	8.70	221	4.13	105
CP7215SV/25SV/55SV -E	9.13	232	4.13	105
CP7215H/55H-E	11.22	285	3.78	96
CP7215HCVE/55HCVE	11.22	285	3.78	96
CP7220/50E	5.0	127	3.7	95
CP7220/50SVE	7.3	186	3.26	83
CP7220/50CVE	7.3	186	3.26	83
CP7220/50HE	9.7	246	3.26	83
CP722/50HCVE	10	255	3.26	83
CP9534/CP9674	7.5	190	3.26	83
CP7263E	5.70	145	2.95	75
CP7263CVE	7.28	185	2.95	75
CP7264E	7.87	200	3.15	80
CP7264ECVE	9.45	240	3.15	80
CP7266E	6.10	155	2.75	70
CP7266CVE	7.67	195	2.75	70
CP7267E	7.28	185	3.94	100
CP7267CVE	8.85	225	3.94	100
CP7268	16.53	420	5.90	150

	L		H		A	
	in	mm	in	mm	in	mm
CP3650...AC4SE	9.37	238	3.44	87.5	1.05	26.8
CP3650...AAE	9.37	238	3.45	87.8	1.05	26.8
CP3650...AB	9.37	238	3.65	92.8	1.05	26.8
CP3850...AB	13.15	334	4.27	107	1.14	29
CP3850...ABVE	13.15	334	4.09	104	1.14	29