

HAMMERS



Ontario's Largest
Pneumatic & Hydraulic Tool Distributor

1-2430 Lucknow Drive, Mississauga, Ontario L5S 1V3. Tel: 905-672-5557 Fax: 905-672-5559
Email: sales@dobcoeqp.com www.dobcoeqp.com

FEATURES & BENEFITS

- Professional industrial grade quality.
- Two handle types to suit your needs: hickory and fiberglass.
- Large selection to meet specific applications and needs.
- Hammer heads are drop forged from premium steel for superior tool life.

Rubber Mallet	216
Claw Hammers	216
Ball Pein Hammers	216
Tinners	217
Sledge Hammers	217
Soft Face Hammers	217
Dead Blow Hammers	218
Brass Hammers	219



Rubber Mallet

Part No.	Head Diameter	Head Length	Overall Length	Replacement Handle Part No.
PH30	2½"	4½"	16½"	HH18



Body Hammer - Bumping

Part No.	Head Sizes	Head Length	Overall Length	Replacement Handle Part No.
PH26	1⅝" round end	4"	12"	HH2



Claw Hammer

Part No.	Face type	Head Weight	Overall Length	Replacement Handle Part No.
220	Plain	20 oz.	13½"	HH12



Claw Hammer w/ Fiberglass Handle

Part No.	Head Weight	Overall Length	Replacement Handle Part No.
GC16	16 oz.	13"	59-853



Ball Pein - Magna-flux Tested

Part No.	Head Weight	Overall Length	Replacement Handle Part No.
212	48 oz.	16½"	HH6
212A	40 oz.	16½"	HH6
212C	32 oz.	15¾"	HH5
212E	24 oz.	15¾"	HH5
212G	16 oz.	13¾"	HH3
212H	12 oz.	12¾"	HH3
212I	8 oz.	11¾"	HH2
212K	4 oz.	10¾"	HH1



Ball Pein Hammer w/Fiberglass Handle

Part No.	Head Weight	Overall Length	Replacement Handle Part No.
GM-16	16 oz.	14"	59-754
GM-24	24 oz.	14"	59-854
GM-32	32 oz.	14"	59-854

Tinners Hammer

Part No.	Head Weight	Overall Length	Replacement Handle Part No.
17A	16 oz.	13"	HH3



Blacksmith - Magna-flux Tested

Part No.	Head Weight	Overall Length	Replacement Handle Part No.
PH19	3 lb.	15"	HH8



Sledge - Magna-flux Tested

Part No.	Head Weight	Overall Length
PH41	4 lb.	15"
PH42	6 lb.	31"
PH43	8 lb.	31"
PH44	10 lb.	35"
PH45	12 lb.	36"
PH46	16 lb.	36"



Club - Magna-flux Tested

Part No.	Head Weight	Overall Length
PH60	2½ lb.	10"
PH61	4 lb.	10"



Soft Face Hammers - Plastic Composition Face with Wood Handle

Face Part No.	Head Dia.	Overall Weight	Tip Length	Replacement	
				Handle Part No.	Tip Part No.
PH15	17/32"	8 oz.	12"	HH15	PH15-TIP
PH20	11 1/32"	16 oz.	12"	HH16	PH20-TIP





SPS Composite Soft Face Hammer Set

Part No.	Description
SPS-155-S8	20 oz. hammer with eight 1½" diameter non marring striking faces, super soft, soft, medium, tough, medium hard, hard, extra-hard, steel, with carrying case.

IMPAX® Soft Face Dead Blow Hammer Set

Part No.	Description
SPI-156-S8	16 oz. dead blow hammer with eight 1½" diameter non marring striking faces, super soft, soft, medium, tough, medium hard, hard, extra-hard, steel, with carrying case.

Non-sparking Soft Face Hammer Set

Part No.	Description
SPS-150N-S8	16 oz. non-sparking hammer with eight non magnetic 1½" diameter striking faces, super soft, soft, medium, tough, medium hard, hard, extra-hard, brass with carrying case.

SPS Composite Soft Face Hammer

Part No.	Weight	Head Diameter	Overall Length
SPS150	16 oz.	1½"	12"
SPS200	24 oz.	2"	14"

Note: Interchangeable tips sold separately. See next page.

IMPAX® Soft Face Dead Blow Hammer

Part No.	Weight	Head Diameter	Overall Length
SPI156	16 oz.	1½"	14"
SPI206	32 oz.	2"	14"

Note: Interchangeable tips sold separately. See next page.

SPI IMPAX® Soft Face Dead Blow Non-sparking Non-Magnetic Hammer

Part No.	Weight	Head Diameter	Overall Length
SPI156N	16 oz.	1½"	14"
SPI206N	32 oz.	2"	14"

Note: Interchangeable tips sold separately. See next page.

Dead Blow Hammer "Power-Drive"

Part No.	Weight	Head Diameter	Overall Length
SF-2	32 oz.	2 1/8"	14"
SF-3	48 oz.	2 3/8"	14 1/2"

Note: Non marring and no bounce.



Strike Pro Dead Blow Hammer

Part No.	Weight	Head Diameter	Overall Length
STPG-24	24 oz.	1 3/4"	12 1/2"

Note: Non marring and no bounce.



Soft Face Hammer Tips

Head Dia.	Standard Part No.	Non-sparking Part No.	Hardness	Colour
1 1/2"	15S	15S-N	Soft	Brown
1 1/2"	15M	15M-N	Medium	Red
1 1/2"	15T	15T-N	Tough	Green
1 1/2"	15SN	15SN-N	Medium-hard	Cream
1 1/2"	15XH	15XH-N	Extra-hard	Yellow
1 1/2"	15SS	15SS-N	Super -soft	Grey
1 1/2"	15H	15H-N	Hard	Black
1 1/2"	15B	15B-N	Brass	Gold
1 1/2"	15ST	—	Steel	Silver
2"	20S	20S-N	Soft	Brown
2"	20M	20M-N	Medium	Red
2"	20T	20T-N	Tough	Green
2"	20SN	20SN-N	Medium-hard	Cream
2"	20XH	20XH-N	Extra-hard	Yellow
2"	20SS	20SS-N	Super-soft	Grey
2"	20H	20H-N	Hard	Black
2"	20B	20B-N	Brass	Gold
2"	20ST	—	Steel	Silver



Brass Hammer with Fiberglass Handle

Part No.	Weight	Head Diameter	Overall Length	Handle Replacement
BRS1.5	24 oz.	1"	12"	59-852
BRS2.5	40 oz.	1 1/4"	12"	59-958



Take Hold... with a new line of mechanics' vises

RELIABLE PERFORMANCE

Made using the highest quality materials to ensure solid reliable performance for life.

SUPERIOR QUALITY

Heavy-duty castings provide superior reliability and excellent service life.

MATERIAL

Made using the highest quality castings, free of impurities, which cause breakage and cracking under load.

MAXIMUM HOLD

Replaceable serrated jaws made of hardened steel provide a secure and reliable hold.



PRECISION NUT AND SCREW

Optimum materials and precision placement of nut and screw provide maximum tool life and clamping strength.

DESIGN

Correct distribution of materials offers: optimal resistance, comfort and safety.

OPTIONAL SWIVEL BASE

360° rotating base with double lockdowns and 3 mounting points ensures maximum maneuverability without compromising stability and safety.

NEW



Mechanics' Vises

Part No.	Jaw Width	Jaw Opening	Jaw Depth	Net Weight (lbs.)
VS3	4"	4¾"	2¾"	33
VS4	4½"	5½"	3"	43
VS5	5"	6½"	3¼"	50
VS6	6"	8"	3⅞"	70
VS8	8"	9"	4"	85

Fibre Grip Jaws*

Part No.	Size	Fits Part No.
VS3-FGJAW	4"	VS3
VS4-FGJAW	4½"	VS4
VS5-FGJAW	5"	VS5
VS6-FGJAW	6"	VS6
VS8-FGJAW	8"	VS8

*Sold in pairs of 2

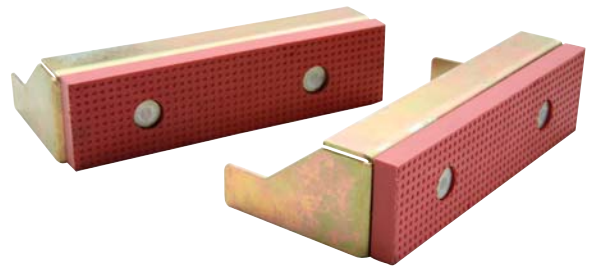

Swivel Bases

Part No.	Diameter	Fits Part No.	Net Weight (lbs.)
SWB3	4"	VS3	4
SWB4	4½"	VS4	5.5
SWB5	5"	VS5	5.7
SWB6*	6"	VS6	9.5
SWB6*	6"	VS8	9.5

*Suitable for the VS6 & VS8



NEW

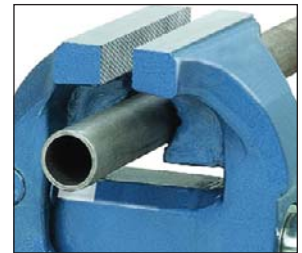
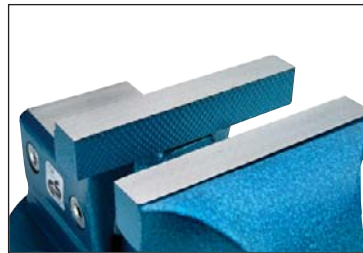

Features:

- Made of robust 1045 steel.
- 92,000+ PSI strength.
- Large capacity permanent pipe jaws.
- Large anvil ideal for hammering and shaping materials.
- Additional tightening of vise is possible by tightening the hex bolts on the side of the vise body.
- Optional swivel base available.

Forged Combination Pipe Vises

Part No.	VS150	VS200
Jaw Width	150mm	200mm
Jaw Opening	7"	8"
Jaw Depth	3"	4"
Min Pipe Capacity	0.38"	0.38"
Max Pipe Capacity	2.5"	3"
Handle Diameter	0.6"	0.7"
Anvil Size	2.5" x 3.75"	3" x 3.75"
Base Diameter	7"	8"
Overall Length	18"	20"
Height	7"	8"
Weight lbs	55	60

Swivel Bases

Part No.	VS150-SB	VS200-SB
Swivel Base Diameter	9"	10"
Mounting Hole Diameter	0.6"	0.7"
Weight lbs	3	4

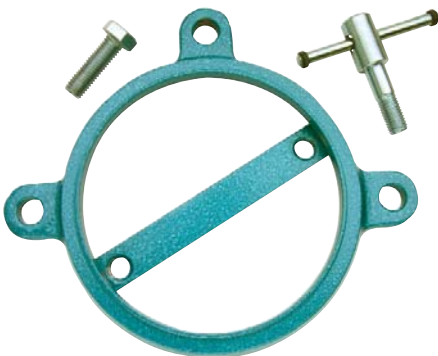

C-CLAMPS & BOLT CUTTERS

DOBCO
EQUIPMENT LTD

C-Clamps

Part No.	Opening Capacity	Throat Depth	Spindle Diameter	Maximum Proof Test, lbs.
C402	0-2"	1¾"	½"	3,500
C403	0-3"	2½"	⅝"	3,500
C404	0-4"	3"	¾"	6,200
C406	0-6"	3⅞"	¾"	6,600
C408	0-8"	4½"	¾"	6,900
C410	0-10"	5"	¾"	8,000
C412	0-12"	5½"	7⁄8"	9,300

Features:

- All C-Clamps are drop forged steel framed.
- Extra throat depth.
- Swivel Perma Pads®.
- Lacquer finish.
- New design frame geometry for maximum strength.
- Forcing screw and pad are plated with copper to resist welding splatter.
- Forcing screw has a sliding T-handle and an impact resistant pad.

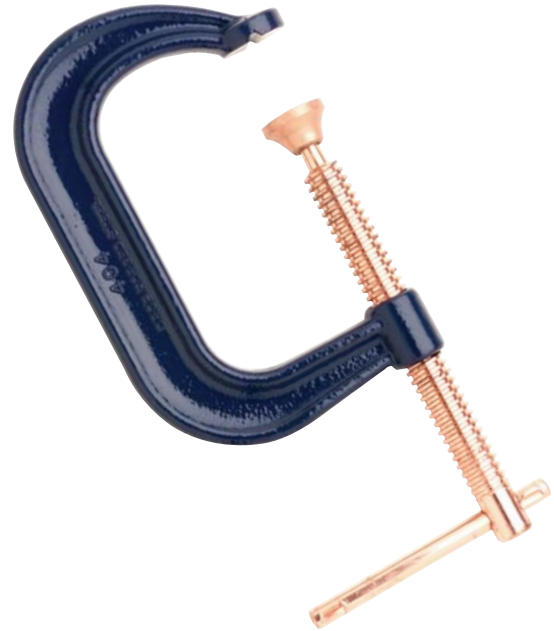

Swivel Pads Replacement

Part No.	Fits C-Clamp Part Number
C402-CAP	C402, C403
C404-CAP	C404, C406, C408
C410-CAP	C410, C412

Bolt Cutters

Overall Part No.	Length	Capacity	Replacement Cutters
BC14	14"	5⁄16"	BC14-CUT
BC18	18"	3⁄8"	BC18-CUT
BC24	24"	7⁄16"	BC24-CUT
BC30	30"	½"	BC30-CUT
BC36	36"	9⁄16"	BC36-CUT

Features:

- All steel tubular handles with rubber grips.
- Lockplate prevents jaw bolts from turning or loosening.
- Eliminates "sloppy" head, ensures trouble free operation.
- Drop forged alloy tool steel jaws with precision ground cutting edges for maximum wear resistance.
- Toggle joint transforms 50 pounds of hand pressure to 4,000 pounds of pressure on cutting edges of jaws.



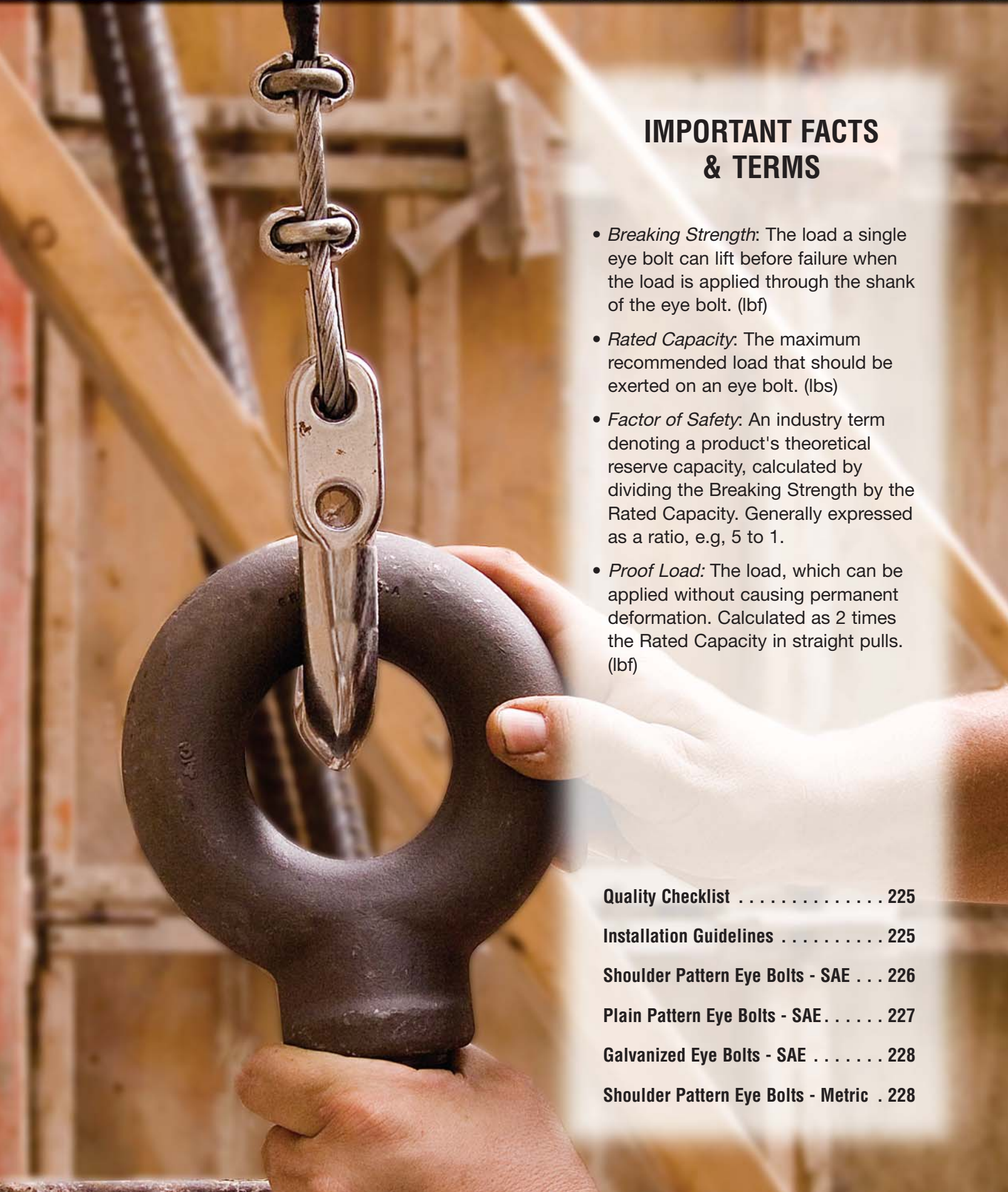

IMPORTANT FACTS & TERMS

- *Breaking Strength:* The load a single eye bolt can lift before failure when the load is applied through the shank of the eye bolt. (lbf)
- *Rated Capacity:* The maximum recommended load that should be exerted on an eye bolt. (lbs)
- *Factor of Safety:* An industry term denoting a product's theoretical reserve capacity, calculated by dividing the Breaking Strength by the Rated Capacity. Generally expressed as a ratio, e.g, 5 to 1.
- *Proof Load:* The load, which can be applied without causing permanent deformation. Calculated as 2 times the Rated Capacity in straight pulls. (lbf)

Quality Checklist	225
Installation Guidelines	225
Shoulder Pattern Eye Bolts - SAE . . .	226
Plain Pattern Eye Bolts - SAE	227
Galvanized Eye Bolts - SAE	228
Shoulder Pattern Eye Bolts - Metric .	228

Quality Checklist

- Forged from bar quality fine grain carbon steel bar.
- Normalized prior to machining.
- Roll threads 1/4" thru 1 1/4" / M6 thru M18.
- Cut threads 1 1/2" thru 2 1/2" / M20 thru M52.
- Proof tested in accordance with ASTM A489 and Federal Spec. ANSI B18.15.
- ASTM A489 test data available on request (no charge with order).
- Shoulder style eye bolt 1/4" thru 1" military style collar - MS51937 specification.
- Shoulder pattern eye bolts undercut to ensure eye bolt will thread tight to shoulder.

Proof Tested to Insure Finest Quality

Minimum breaking strengths are based on vertical loading and verified by actual physical testing of samples chosen via random selection from each lot of a size produced. Actual breaking tests are performed on sample specimens.

Eye Bolt Rated Capacity

The rated capacity refers to the load a single eye bolt can lift when the load is applied through the shank of the eye bolt. Breaking strength is five times the rated capacity. The rated capacity is drastically reduced when the load is applied to the eye bolt at an angle. The load should never be applied at more than a 45 degree angle from the bolt centerline. The rated capacity is reduced to 25% when the load is applied at a 45 degree angle to the eye bolt centerline. When more than one eye bolt is used to lift an evenly distributed load the capacity is reduced on each eye bolt, based on the angle of the load.

Eye Bolt Installation Guidelines ...

Right

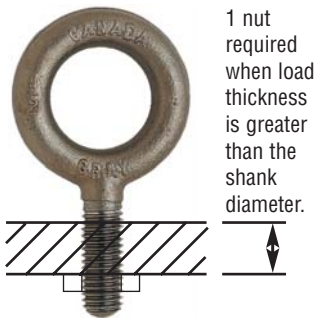

1 nut required when load thickness is greater than the shank diameter.

Tighten hex nut securely against load.

Right

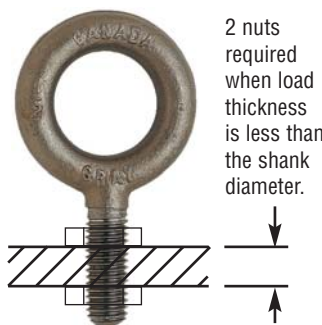

2 nuts required when load thickness is less than the shank diameter.

Tighten hex nut securely against load.

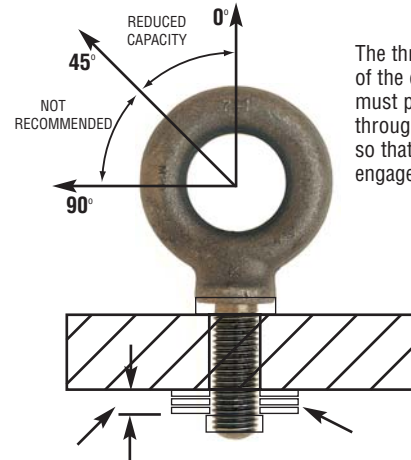

The threaded part of the eye bolt must penetrate through the load so that the nut engages fully.

- As shown in the diagram, place washer or spacers between the nut and the load.
- When threading eye bolt into non-chambered hole, a washer should be used.

Right

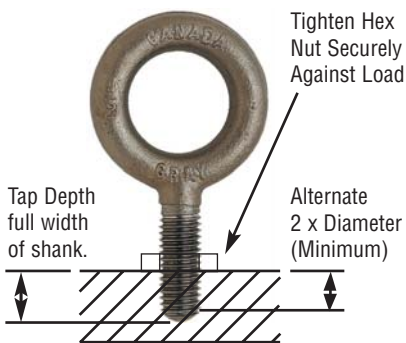

Tighten Hex Nut Securely Against Load

Alternate 2 x Diameter (Minimum)

Tap Depth full width of shank.

Wrong

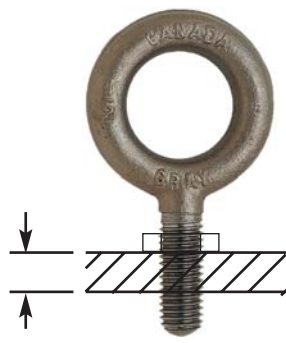

One eye bolt diameter or less.

Shim added to change eye alignment 90°



Minimum tap depth is basic shank length plus one-half the normal eye bolt diameter.

Shoulder Pattern

Forged - Carbon Steel - Self Colored

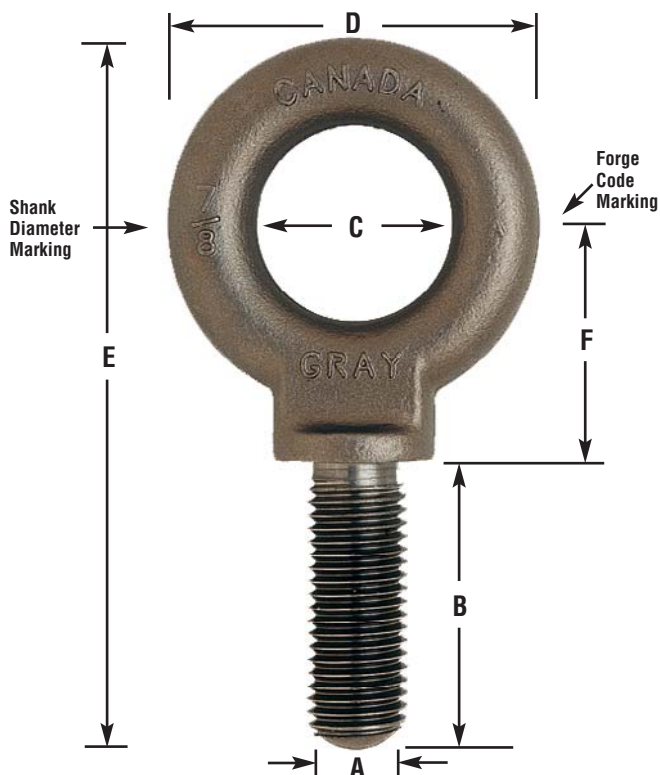

Shoulder & Plain Eye Bolts

Material Data:

Grade.....C1030

Mechanical Properties:

Grain Size.....5 or Finer

Tensile Strength.....65,000 psi min.

Yield.....50,000 psi min.

Elongation.....30% min.

Reduction of Area.....60% min.

WARNING

RATED CAPACITY LIMIT IS DRASTICALLY REDUCED WHEN LOADING AT ANY ANGLE. LOADING MUST NEVER BE MADE AT AN ANGLE GREATER THAN 45° FROM BOLT CENTERLINE. AT AN ANGLE OF 45° RATED CAPACITY IS REDUCED TO ¼ OF THE TABULATED VALUE.

Direction of Pull	Rated Capacity
45 degrees	30% of rated capacity
90 degrees	25% of rated capacity

Dimensions in Inches

Weights in Pounds

Part No.	Thread Size UNC-2A A	Shank Length B	I.D. Eye C	O.D. Eye D	Overall Length E	Center of Eye to Shdr. F	Approx. Weight per Piece	Rated Capacity lbs.
BS08	1/4-20	1	3/4	1 3/16	2 3/8	3/4	0.04	650
BS10	5/16-18	1 1/8	7/8	1 7/16	2 13/16	15/16	0.09	1,200
BS12	3/8-16	1 1/4	1	1 11/16	3 9/32	1 1/8	0.17	1,550
BS14	7/16-14	1 3/8	1 1/16	1 13/16	3 9/16	1 1/4	0.24	2,000
BS16	1/2-13	1 1/2	1 3/16	2 1/8	3 31/32	1 3/8	0.38	2,600
BS18	9/16-12	1 5/8	1 1/4	2 5/16	4 1/2	1 9/16	0.51	3,200
BS20	5/8-11	1 3/4	1 3/8	2 9/16	4 3/4	1 21/32	0.71	5,200
BS24	3/4-10	2	1 1/2	2 13/16	5 1/4	1 13/16	0.99	7,200
BS28	7/8-9	2 1/4	1 11/16	3 3/16	5 31/32	2 1/8	1.48	10,600
BS32	1-8	2 1/2	1 13/16	3 9/16	6 5/8	2 5/16	2.20	13,300
BS36	1 1/8-7	2 3/4	2	4 1/16	7 17/32	2 11/16	3.20	17,000
BS40	1 1/4-7	3	2 3/16	4 7/16	8 7/32	2 15/16	4.40	21,000
BS48	1 1/2-6	3 1/2	2 1/2	5 3/16	9 15/32	3 5/16	7.40	24,000
BS56	1 3/4-5	3 3/4	2 7/8	6	10 13/16	4	11.80	32,000
BS64	2-4 1/2	4	3 3/8	6 7/8	11 7/8	4 3/8	17.20	40,000

Note: Proof tested in accordance with ASTM A489 and Federal Spec. ANSI B18.15. Traceability and Mechanical test values are available with each shipment upon request.

Plain Pattern

Forged - Carbon Steel - Self Colored

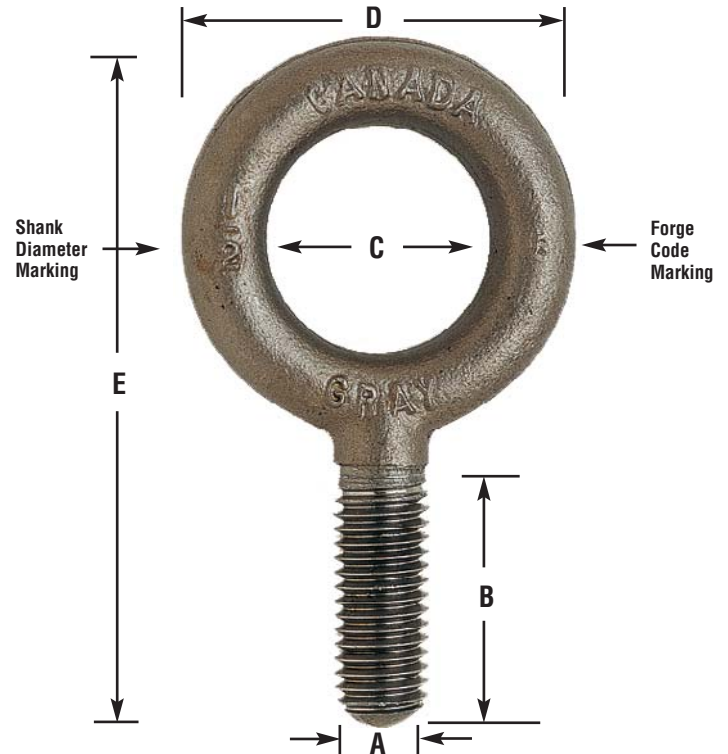

WARNING

RATED CAPACITY LIMIT IS DRASTICALLY REDUCED WHEN LOADING AT ANY ANGLE. LOADING MUST NEVER BE MADE AT AN ANGLE GREATER THAN 45° FROM BOLT CENTERLINE. AT AN ANGLE OF 45° RATED CAPACITY IS REDUCED TO ¼ OF THE TABULATED VALUE.

Direction of Pull	Rated Capacity
45 degrees	30% of rated capacity
90 degrees	25% of rated capacity

Dimensions in Inches

Weights in Pounds

Part No.	Thread Size UNC-2A A	Shank Length B	I.D. Eye C	O.D. Eye D	Overall Length E	Approx. Weight per Piece	Rated Capacity lbs.
BP08	1/4-20	1	3/4	13/16	27/32	0.04	650
BP10	5/16-18	1 1/8	7/8	17/16	219/32	0.09	1,200
BP12	3/8-16	1 1/4	1	1 1/16	3	0.14	1,550
BP14	7/16-14	1 3/8	1 3/32	1 13/16	37/32	0.19	2,000
BP16	1/2-13	1 1/2	1 3/16	2 1/8	3 21/32	0.31	2,600
BP18	9/16-12	1 5/8	1 1/4	2 5/16	4	0.41	3,200
BP20	5/8-11	1 3/4	1 3/8	2 9/16	4 1/2	0.59	5,200
BP24	3/4-10	2	1 1/2	2 13/16	4 7/8	0.88	7,200
BP28	7/8-9	2 1/4	1 11/16	3 3/16	5 1/2	1.40	10,600
BP32	1-8	2 1/2	1 13/16	3 9/16	6 1/8	2.00	13,300
BP36	1 1/8-7	2 3/4	2	4 1/16	6 7/8	2.80	17,000
BP40	1 1/4-7	3	2 3/16	4 7/16	8	4.00	21,000
BP48	1 1/2-6	3 1/2	2 1/2	5 3/16	8 3/4	7.40	24,000
BP56	1 3/4-5	3 3/4	2 7/8	6	9 13/16	11.80	32,000
BP64	2-4 1/2	4	3 3/8	6 7/8	11	17.40	40,000

Note: Proof tested in accordance with ASTM A489 and Federal Spec. ANSI B18.15. Traceability and Mechanical test values are available with each shipment upon request.

Shoulder Pattern

Forged - Carbon Steel - Galvanized

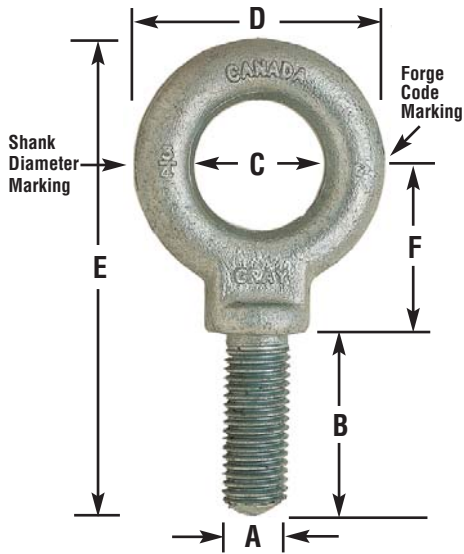

GALVANIZED EYE BOLTS

Dimensions in Inches

Part No.	Thread Size	Shank Length	I.D. Eye	O.D. Eye	Overall Length	Center of Eye to Shdr.	Weights in Pounds	
	UNC-2A						A	B
88708	1/4-20	1	3/4	1 3/16	2 3/8	3/4	0.04	650
88710	5/16-18	1 1/8	7/8	1 7/16	2 13/16	15/16	0.09	1,200
88712	3/8-16	1 1/4	1	1 11/16	3 9/32	1 1/8	0.17	1,550
88714	7/16-14	1 3/8	1 1/16	1 13/16	3 9/16	1 1/4	0.24	2,000
88716	1/2-13	1 1/2	1 3/16	2 1/8	3 31/32	1 3/8	0.38	2,600
88718	9/16-12	1 5/8	1 1/4	2 5/16	4 1/2	1 9/16	0.51	3,200
88720	5/8-11	1 3/4	1 3/8	2 9/16	4 3/4	1 21/32	0.71	5,200
88724	3/4-10	2	1 1/2	2 13/16	5 1/4	1 13/16	0.99	7,200
88728	7/8-9	2 1/4	1 11/16	3 3/16	5 31/32	2 1/8	1.48	10,600
88740	1 1/4-7	3	2 3/16	4 7/16	8 7/32	2 15/16	4.40	21,000

Note: Proof tested in accordance with ASTM A489 and Federal Spec. ANSI B18.15. Traceability and Mechanical test values are available with each shipment upon request.

Shoulder Pattern

Forged - Carbon Steel - Self Colored

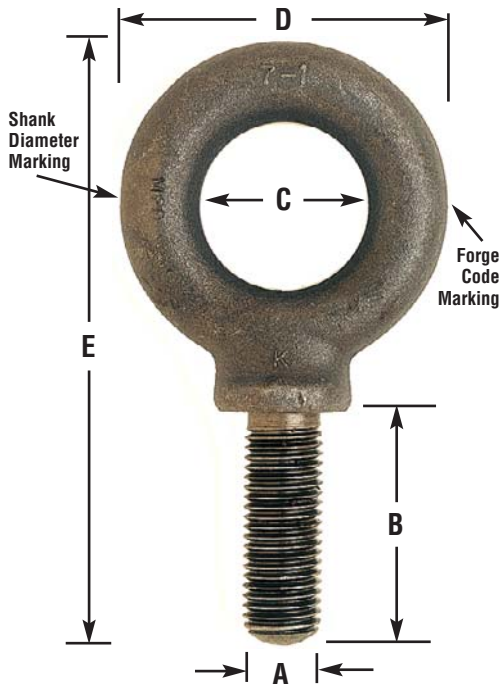

METRIC EYE BOLTS

Dimensions in Millimeters

Part No.	Thread Size	Shank Length	I.D. Eye	O.D. Eye	Overall Length	Approx. Weight per piece	Rated Capacity kgs/lbs.
	ISO-Course-6G						
BS6M	M6x1.0	25.4	19	30	60.3	0.06	210/462
BS7M	M7x1.0	28.5	22	36.5	71.4	0.10	370/814
BS8M	M8x1.25	31.7	25	43	82.5	0.17	500/1,110
BS10M	M10x1.5	35.0	27	46	90.5	0.24	740/1,628
BS12M	M12x1.75	38.0	30	54	100.8	0.36	1,030/2,266
BS14M	M14x2.0	44.5	35	65	120.7	0.48	1,600/3,520
BS16M	M16x2.0	44.5	35	65	120.7	0.69	1,600/3,520
BS18M	M18x2.5	51.0	38	71.5	133.3	1.10	2,140/4,708
BS20M	M20x2.5	57.0	41	81	152.4	1.51	2,860/6,292
BS24M	M24x3.0	63.5	44	90.4	168.3	2.36	3,850/8,470
BS27M	M27x3.0	70.0	51	103	191.3	3.41	5,200/11,440
BS30M	M30x3.5	76.0	55	112.7	208.8	4.68	6,400/14,080
BS36M	M36x4.0	89.0	63	131.8	240.5	7.77	8,970/19,734
BS42M	M42x4.5	95.0	73	152.4	274.7	11.10	11,960/26,312
BS45M	M45x4.5	95.0	73	152.4	274.7	11.35	12,720/27,984
BS48M	M48x5.0	101.6	82	174.6	301.6	15.90	16,400/36,080
BS52M	M52x5.0	101.6	82	174.6	301.6	16.70	17,300/38,060

Note: Proof tested in accordance with ASTM A489 and Federal Spec. ANSI B18.15. Traceability and Mechanical test values are available with each shipment upon request.