

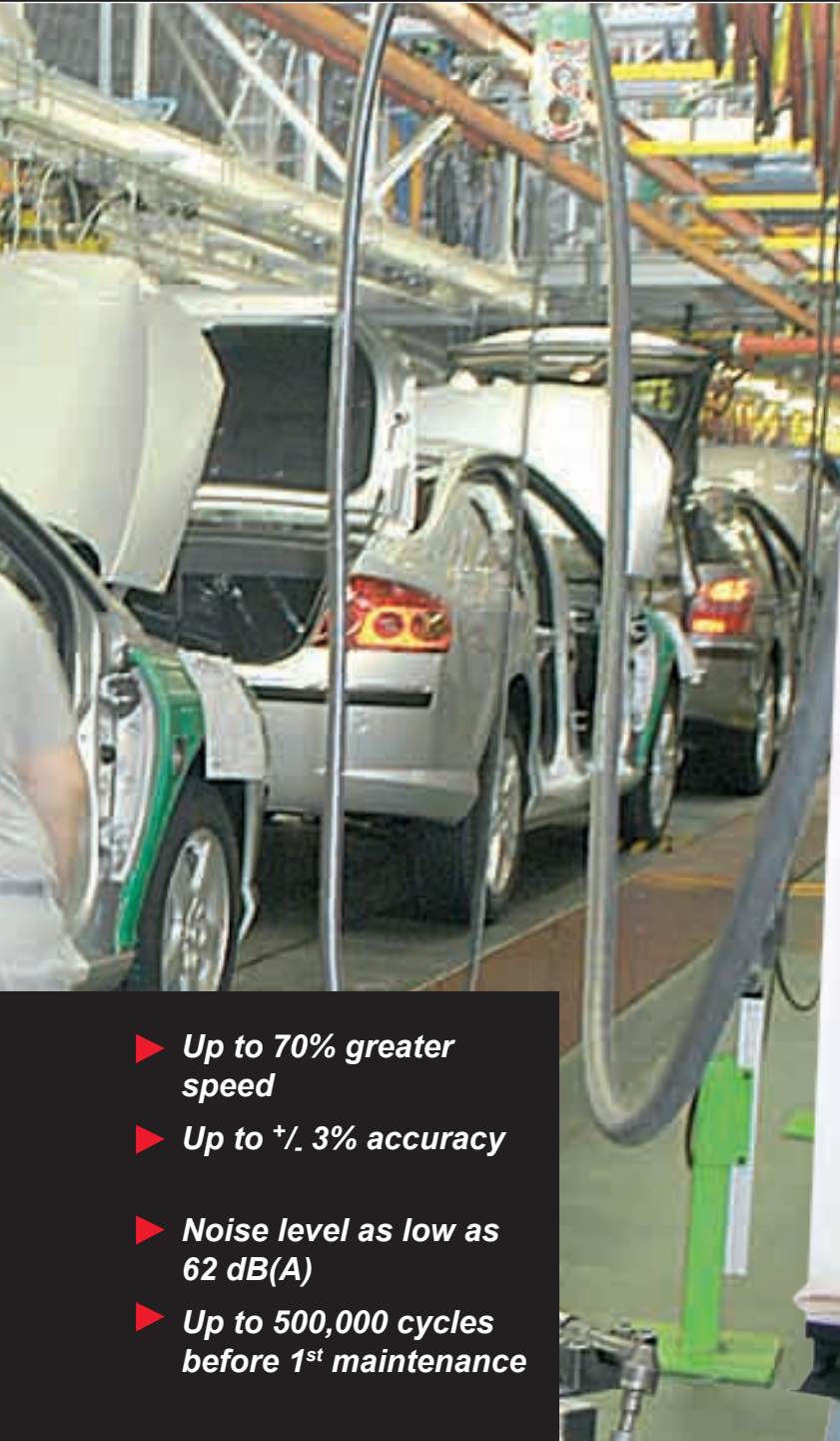

# Industrial Tools



- ▶ *Up to 70% greater speed*
- ▶ *Up to +/- 3% accuracy*
- ▶ *Noise level as low as 62 dB(A)*
- ▶ *Up to 500,000 cycles before 1<sup>st</sup> maintenance*

**DOBCO**  
EQUIPMENT LTD

Toll-Free 1-866-763-6226 Phone: 905-672-5557  
Fax: 905-672-5559 Email: [sales@dobcoeqp.com](mailto:sales@dobcoeqp.com)

**NUTRUNNERS**  
*You deserve more*

# Electric PLUG & TIGHTEN - CVIP



High speed Accuracy!

## Productivity

- High speed 1390 rpm
- Easy set up in 60 sec.
- 5 torque presets (Tflex only)

**[NEW]**

Up to 70% greater speed with lower energy => cost savings

## Quality

- +/- 3% accuracy at 6 sigma
- Error proofing with Torque/Angle strategy\*

Less reworking and warranty claims  
=> cost savings

## Ergonomics

- 62 dB(A) noise level
- Low reaction force

Less operator downtime  
=> cost savings

## Durability

- up to 500,000 cycles before 1<sup>st</sup> maintenance
- Calibration twice a year

Less service time  
=> cost savings

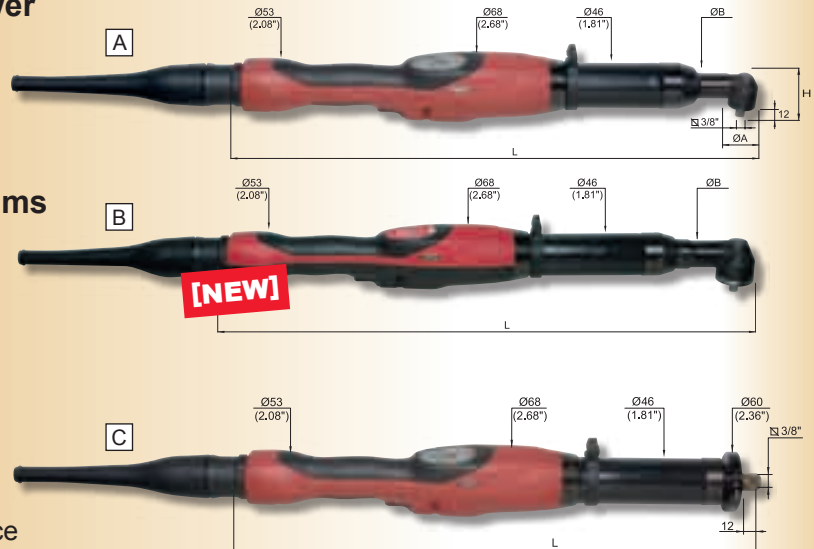

MODEL	ANGLE HEAD DIMENSIONS					
	ØA		ØB		H	
	mm	in.	mm	in.	mm	in.
EAP1.5-15-	28	1.10	27	1.06	45.5	1.79
EAP1.5-20-	28	1.10	27	1.06	45.5	1.79
EAP1.5-26-	28	1.10	27	1.06	45.5	1.79
EAP2-20-	28	1.10	27	1.06	45.5	1.79
EAP2-30-	28	1.10	27	1.06	45.5	1.79
EAP2-40-	35	1.38	27	1.06	51.5	2.03
EAP2-65-	40	1.57	30.5	1.20	57.5	2.26

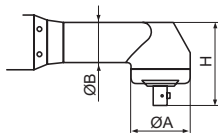

## [Option]

- PLC External control
- OK / NOK reporting
- Batch count

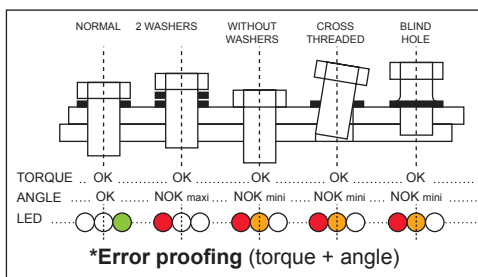

## MORE FEATURES

- Low energy consumption (50 Watts)
- Joint stiffness setting (Tflex only) **[NEW]**
- OK/NOK feedback on tool display
- Data recording (Tflex only) **[NEW]**
- Oil & dust free
- Long life electric brushless motor without friction



EXCLUSIVELY from [www.plugandtighten.com](http://www.plugandtighten.com)

# CVIP

(2.2 to 47.9 ft-lb) 3 to 65 Nm

PIC REF	MODEL	PART NUMBER	MODEL	PART NUMBER	OUTPUT DRIVE			ROTATIONAL SPEED	LENGTH L		WEIGHT	
					in.	Nm	ft. lb.		mm	in.	kg	lb

**Right angle tools - 230V Models**

		Torque		Torque + Angle					rpm 230V			
A	EAP1.5-15-T-2	615 165 312 0	EAP1.5-15-TA-2	615 165 323 0	Sq. 3/8	3-15	2.2-11.0	1020	534.5	21.0	1.85	4.1
A	EAP1.5-20-T-2	615 165 313 0	EAP1.5-20-TA-2	615 165 324 0	Sq. 3/8	5-20	3.7-14.7	800	534.5	21.0	1.85	4.1
A	EAP1.5-26-T-2	615 165 314 0	EAP1.5-26-TA-2	615 165 325 0	Sq. 3/8	7-26	5.2-19.2	570	534.5	21.0	1.85	4.1
A	EAP2-20-T-2	615 165 315 0	EAP2-20-TA-2	615 165 326 0	Sq. 3/8	5-20	3.7-14.7	1320	559.5	22.0	2.0	4.4
A	EAP2-30-T-2	615 165 316 0	EAP2-30-TA-2	615 165 327 0	Sq. 3/8	7-30	5.2-22.1	1020	559.5	22.0	2.0	4.4
A	EAP2-40-T-2	615 165 317 0	EAP2-40-TA-2	615 165 328 0	Sq. 3/8	10-40	7.4-29.5	800	570.0	22.4	2.1	4.6
A	EAP2-65-T-2	615 165 318 0	EAP2-65-TA-2	615 165 329 0	Sq. 3/8	15-65	11-47.9	510	581.5	22.9	2.2	4.8

**Right angle Tflex tools - 230V Models**

B	EAP2-30-TF2	615 165 404 0			Sq. 3/8	6-30	4.4-22.1	1020	559.5	22.0	2.0	4.4
B	EAP2-65-TF2	615 165 405 0			Sq. 3/8	15-65	11-47.9	510	581.5	22.9	2.2	4.8

**Right angle tools - 110V Models**

		Torque		Torque + Angle					rpm 110V			
A	EAP1.5-15-T-1	615 165 334 0	EAP1.5-15-TA-1	615 165 345 0	Sq. 3/8	3-15	2.2-11.0	690	534.5	21.0	1.85	4.1
A	EAP1.5-20-T-1	615 165 335 0	EAP1.5-20-TA-1	615 165 346 0	Sq. 3/8	5-20	3.7-14.7	540	534.5	21.0	1.85	4.1
A	EAP1.5-26-T-1	615 165 336 0	EAP1.5-26-TA-1	615 165 347 0	Sq. 3/8	7-26	5.2-19.2	340	534.5	21.0	1.85	4.1
A	EAP2-20-T-1	615 165 337 0	EAP2-20-TA-1	615 165 348 0	Sq. 3/8	5-20	3.7-14.7	890	559.5	22.0	2.0	4.4
A	EAP2-30-T-1	615 165 338 0	EAP2-30-TA-1	615 165 349 0	Sq. 3/8	7-30	5.2-22.1	690	559.5	22.0	2.0	4.4
A	EAP2-40-T-1	615 165 339 0	EAP2-40-TA-1	615 165 350 0	Sq. 3/8	10-40	7.4-29.5	540	570.0	22.4	2.1	4.6
A	EAP2-65-T-1	615 165 340 0	EAP2-65-TA-1	615 165 351 0	Sq. 3/8	15-65	11-47.9	340	581.5	22.9	2.2	4.8

**Right angle Tflex tools - 110V Models**

B	EAP2-30-TF1	615 165 402 0			Sq. 3/8	6-30	4.4-22.1	690	559.5	22.0	2.0	4.4
B	EAP2-65-TF1	615 165 403 0			Sq. 3/8	15-65	11-47.9	340	581.5	22.9	2.2	4.8

		Torque		Torque + Angle					rpm 230V			
<b>In-line tools - 230V Models</b>												
C	EDP1.5-15-T-2	615 165 319 0	EDP1.5-15-TA-2	615 165 330 0	Hex. 1/4F	3-15	2.2-11.0	1010	491.5	19.3	1.7	3.7
C	EDP2-24-T-2	615 165 320 0	EDP2-24-TA-2	615 165 331 0	Hex. 1/4F	5-24	3.7-17.7	1390	516.5	20.3	1.8	3.9
C	EDP2-33-T-2	615 165 321 0	EDP2-33-TA-2	615 165 332 0	Sq. 3/8	7-33	5.2-24.3	1010	508.5	20.0	1.85	4.1
C	EDP2-43-T-2	615 165 322 0	EDP2-43-TA-2	615 165 333 0	Sq. 3/8	8-43	5.9-31.7	780	508.5	20.0	1.85	4.1
<b>In-line tools - 110V Models</b>												
C	EDP1.5-15-T-1	615 165 341 0	EDP1.5-15-TA-1	615 165 352 0	Hex. 1/4F	3-15	2.2-11.0	680	491.5	19.3	1.7	3.7
C	EDP2-24-T-1	615 165 342 0	EDP2-24-TA-1	615 165 353 0	Hex. 1/4F	5-24	3.7-17.7	940	516.5	20.3	1.8	3.9
C	EDP2-33-T-1	615 165 343 0	EDP2-33-TA-1	615 165 354 0	Sq. 3/8	7-33	5.2-24.3	680	508.5	20.0	1.85	4.1
C	EDP2-43-T-1	615 165 344 0	EDP2-43-TA-1	615 165 355 0	Sq. 3/8	8-43	5.9-31.7	525	508.5	20.0	1.85	4.1

EAP. / EDP.		ACCESSORIES INCLUDED	
ITEM	PART NO.	DESCRIPTION	PART NO.
		• Horizontal bail	615 396 562 0
		• Reaction bar ring	615 396 551 5
OPTIONAL ACCESSORIES			
1	615 396 547 0	Mounting plate with telescopic spindle	615 396 547 0
2	615 396 553 0	2nd lever start	615 396 553 0
3	615 396 554 0	Reaction handle	615 396 554 0
4	615 396 529 0	Horizontal bail, swivel	615 396 529 0
5	467003	Vertical bail	467003
6	615 573 064 0	Plastic protective cover EAP. -15/20/30	615 573 064 0
6	615 573 065 0	Plastic protective cover EAP 2-40	615 573 065 0
6	615 573 066 0	Plastic protective cover EAP 2-65	615 573 066 0
6	615 573 067 0	Plastic protective cover EDP	615 573 067 0
	615 917 470 0	• Power cable EU 230 V - 5 m (16.4 ft)	615 917 470 0
	615 917 476 0	• Power cable EU 230 V - 5 m (16.4 ft) with GFI	615 917 476 0
	615 917 472 0	• Power cable UK 230 V - 5 m (16.4 ft)	615 917 472 0
	615 917 478 0	• Power cable UK 230 V - 5 m (16.4 ft) with GFI	615 917 478 0
	615 917 479 0	• Power cable US 110 V - 5 m (16.4 ft) with GFI	615 917 479 0
	615 917 474 0	• Power cable without plug 230 V - 5 m (16.4 ft)	615 917 474 0
	615 917 477 0	• Power cable without plug 230 V - 5 m (16.4 ft) with GFI	615 917 477 0
	615 917 475 0	• Power cable without plug 110 V - 5 m (16.4 ft)	615 917 475 0
	615 917 498 0	• Power cable without plug 110 V - 5 m (16.4 ft) with GFI	615 917 498 0

A GFI (Ground Fault Interrupter) is an additional user safety protection. It is strongly recommended to if your line is not already protected

MODEL	PART NUMBER	DIMENSIONS					
		WIDTH		HEIGHT		DEPTH	
		mm	in.	mm	in.	mm	in.
DTU Basic	615 936 045 0	90	3.5	250	9.8	190	7.5

Please also specify TOOL CABLE and POWER CABLE



TOOL CABLE		PART NO.
• Tool cable 110 V 5 m (16.4 ft)		615 917 485 0
• Tool cable 110 V 10 m (32.8 ft)		615 917 486 0
• Tool cable 110 V 15 m (49.2 ft)		615 917 487 0
• Tool cable 230 V 5 m (16.4 ft)		615 917 480 0
• Tool cable 230 V 10 m (32.8 ft)		615 917 481 0
• Tool cable 230 V 15 m (49.2 ft)		615 917 482 0
POWER CABLE		PART NO.
A European 2.5 m (8.2 ft)		615 917 201 0
B UK 2.5 m (8.2 ft)		615 917 202 0
C US 2.5 m (8.2 ft)		615 917 203 0
OPTIONAL EXTENSION CABLE		PART NO.
• Extension tool cable 10 m (32.8 ft)		615 917 483 0
• Extension tool cable 20 m (65.6 ft)		615 917 484 0





# Pneumatic SHUT OFF - SH

## Versatile Productivity!



### Productivity

High speed 1100 rpm  
Wide torque range 1.8 to 88 ft.lb (2.5 to 120 Nm)  
**High speed with joint stiffness capability**  
=> cost savings

### Quality

Consistent mean torque  
Immediate shut off for high accuracy (+/- 6% at 6 sigma)  
**Consistent mean torque**  
=> cost savings

### Ergonomics

Low reaction force on hard joint  
Easy to set torque  
**Less operator downtime**  
=> cost savings

### Durability

Up to 250,000 cycles before 1<sup>st</sup> maintenance  
Very quick to dismantle & assemble with few service tools  
**Quick service time**  
=> cost savings

### [Option]

PLC External control  
OK / NOK reporting  
Batch count

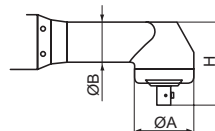

MODEL	ANGLE HEAD DIMENSIONS					
	ØA		ØB		H	
	mm	in.	mm	in.	mm	in.
SH70	20	0.79	20	0.79	36,6	1.44
SH150	22	0.87	21	0.83	35,2	1.38
SH200	27	1.06	27	1.06	45,5	1.79
SH280	27	1.06	24	0.94	41,5	1.63
SH500	40	1.57	29	1.1	56,5	2.2
SH700	40	1.57	29	1.1	56,5	2.2
SH850	51	2.0	33	1.3	69,5	2.7
SH1200	51	2.0	33	1.3	69,5	2.7



### MORE FEATURES

- Excellent power to weight ratio (M8 screws at 18.4 ft.lb (25 Nm) => 3.1 lb (1.4 kg)
- Integrated air signal part
  - Easy to set torque
- Very good joint stiffness capability (from hard to very soft joints)





Toll-Free 1-866-763-6226 Phone: 905-672-5557  
Fax: 905-672-5559 Email: [sales@dobcoeqp.com](mailto:sales@dobcoeqp.com)



Toll-Free 1-866-763-6226 Phone: 905-672-5557  
Fax: 905-672-5559 Email: [sales@dobcoeqp.com](mailto:sales@dobcoeqp.com)



Chicago  
Pneumatic

*Desoutter*

**GEORGES  
RENAULT**

**SCANROTOR**

*techmotive*

USA  
Part No 615 993 666 8  
© Copyright 2007 CP

## 1.8 to 88 ft-lb (2.5 to 120 Nm)

PIC REF	MODEL	PART NUMBER	BOLT SIZE	FREE SPEED	OUTPUT DRIVE	TORQUE RANGE		LENGTH		WEIGHT		AIR FLOW		AIR INLET	HOSE INT. Ø	
						Nm	ft.lb	mm	in.	kg	lb.	l/s	cfm	in.	mm	in.
A	SH70-LR1100-S90-A4S	205 147 628 4	M5	1100	1/4 sq.	2.5-7	1.8-5	334	13.1	1.3	2.9	8	17	1/4	8	3/16
B	SH150-LR580-S90-A10S	205 147 629 4	M6	560	3/8 sq.	7-15	5-11	349	13.7	1.4	3.1	10	21	1/4	10	3/8
C	SH200-LR550-S90-A10S	205 147 630 4	M6	530	3/8 sq.	10-19	7-15	355	14.0	1.4	3.1	10	21	1/4	10	3/8
D	SH280-LR350-S90-A10S	205 147 631 4	M8	340	3/8 sq.	14-28	10-21	350	13.8	1.4	3.1	10	21	1/4	10	3/8
D	SH280-LR80-S90-A10S	205 147 632 4	M8	80	3/8 sq.	14-28	10-21	350	13.8	1.4	3.1	10	21	1/4	10	3/8
E	SH500-LR330-S90-A13S	205 147 473 4	M10	330	1/2 sq.	25-50	18-36	453	17.8	2.2	4.8	16	34	1/4	10	3/8
F	SH700-LR225-S90-A13S	205 147 474 4	M10-M12	225	1/2 sq.	34-70	24-50	487	19.2	2.4	5.3	16	34	1/4	10	3/8
G	SH850-LR190-S90-A13S	205 147 475 4	M12	190	1/2 sq.	40-85	29-61	530	20.8	2.8	6.1	16	34	1/4	10	3/8
H	SH1200-LR215-S90-A13S	205 147 476 4	M12-M14	215	1/2 sq.	70-120	51-88	590	23.2	3.5	7.6	28	59	1/2	13	1/2

### ACCESSORIES INCLUDED



	SH70/150/200/280	SH500/700/850	SH1200
· Screwdriver adjustment	205 050 785 3	205 050 785 3	205 050 785 3
· Air hose nipple		453973	205 051 239 3

### OPTIONAL ACCESSORIES



ITEM	PART NO.
1 Exhaust hose for all models (except SH1200)	459813
1 Exhaust hose for SH1200	205 050 181 3
2 Suspension bail for all models (except SH1200)	205 051 113 3
2 Suspension bail for SH1200	615 396 562 0
3 Swiveling bail for SH500/700/850	205 051 115 3
3 Swiveling bail for SH1200	205 051 232 3
3 Swiveling bail for SH70/150/200/280	205 011 423 2
4 Protective cover for SH500	205 050 182 3
4 Protective cover for SH700	205 050 235 3
4 Protective cover for SH850	205 050 238 3
4 Protective cover for SH1200	205 050 252 3
4 Protective cover for SH70/150/200/280	205 011 426 2
5 Reporting kit for HS70 (for connection with FAS)	205 011 424 2
5 Reporting kit for HS150/200/280 (for connection with FAS)	205 011 425 2
5 Reporting kit for HS500/700/850 (for connection with FAS)	205 050 175 3
5 Reporting kit for HS1200 (for connection with FAS)	205 050 176 3



MODEL	PART NUMBER	DIMENSIONS			WEIGHT		SUPPLY VOLTAGE				
		LENGHT	WIDTH	HEIGHT	kg	lb					
		mm	in.	mm	in.	mm	in.	kg	lb		
FAS3000	205 146 677 4	317	12.5	161	6.4	87	3.4	3	6.6	AC220-240V, 50Hz & AC110-120V, 60Hz	



### START-UP KIT

to be ordered with the FAS3000		PART NO.
POWER CABLE AND PLUG	LENGHT	
A Power cable Europe	2 m (78")	396853
B Power cable USA	2 m (78")	459323
C Power cable UK	2 m (78")	396843



### ACCESSORIES INCLUDED

	LENGHT	PART NO.
D Sensor Assembly	2 m (78")	205 047 908 3
2 of these are needed per unit		
E Sensor electric cord	5 m (197")	205 047 964 3

**Calibration Delta 5000**  
Measurement of torque and angle value



**Fastening accessories**  
Bits and Sockets



See our general catalogue



# your profit

## Through **ERGONOMICS**

**In major assembly plants, 75% of lost working days are related to ergonomics.**

**What is your annual cost for this loss?**

- Fastest motor + immediate shut off response
- = final torque reached earlier
- = shorter operator exposure:
- + less vibration (<2.5 m/s<sup>2</sup>)
- + less reaction force
- + lower noise (from 76 to 62 dB(A))

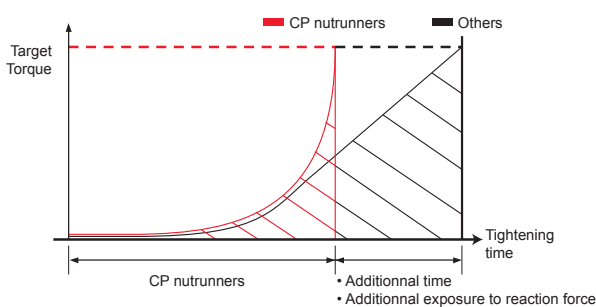

## Through **DURABILITY**

**15% of the yearly global cost for an assembly tool is spent on maintenance.**

**What is your annual maintenance cost?**

Designed for high cycle operations, CP Nutrunners will keep performing through long service intervals, year after year (up to 500,000 cycles before 1<sup>st</sup> maintenance)

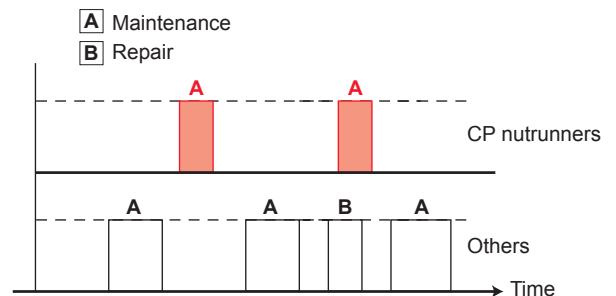

### Safety Manager



«Developed with our operators' input, these tools have key ergonomic features covered. This has decreased operation downtime, and we have a motivated workforce.»



### Maintenance Engineer

«Very easy to maintain, CP nutrunners make my life easier with parts in stock, great technical support and their quick dismantling & assembly time»

## ERGONOMICS

 Reaction force	 Weight	 Vibration	 Noise	 Clean working environment
---	---	--	--	--

### Electric PLUG & TIGHTEN



### Pneumatic ANGLE HEAD



● = Not Recommended ● ● = Good ● ● ● = Perfect



For CVIP PLUG & TIGHTEN see inside on left

## DURABILITY

 Maintenance	 Reliability	 Support
---	--	--

